



Ball Lock[®]

MOUNTING SYSTEM

PRE-ENGINEERED BALL LOCK[®] MOUNTING SYSTEMS FOR MAZAK MACHINES



Mazak

VCN-410A
VCN-410B
VCN-510C
FJV200
FJV-250

Jergens[®]

MANUFACTURING EFFICIENCY

Table of Contents

Ball Lock® Selection Guide How TO.....	3 - 4
Ball Lock® Mounting Systems Components	5
Fixture Plates	6 - 7
Ball Lock® Base Vises	8
Mazak Models	9 - 60
Nexus 410A.....	9 - 14
Nexus 410B	15 - 25
Nexus 510C	26 - 41
FJV - 200	42 - 48
FJV - 250	49 - 60
Subplate & Mounting Hardware Order Form	61 - 62

Copyright Jergens
2015 Jergens, Inc.

Ball Lock Selection Guide

How To Use This Guide

1. Review the "How the Ball Lock Mounting System Works" section for an overview of the system and components
2. Select a specific machine tool model and subplate.
 - a. The opening machine model page includes the machine table specifications used for that machine.
 - b. The following page/pages contain specific subplates designed for that machine model and table specifications.
 - c. Each subplate page lists the color coded fixture plates that will fit that subplate. Each machine may have one or more subplate/fixture plate combinations.
 - d. Use the "fixture plate examples" contained in the guide to help select a fixture plate for typical applications. Fixture plates are color coded to assist in using the example when selecting it for a specific machine.
 - e. Use the check boxes to identify subplates to be selected. You can then print these pages for reference when preparing a request for quote or placing an order.
3. Use the "Subplate Mounting and Quote Form" to assist in selecting the required subplate mounting components.
 - a. This form lists the required mounting hardware for each subplate you select.
 - b. You can fill in the number of subplates into the form for reference.
 - c. The mounting hardware listed is for one subplate. When requesting a quote or ordering more than one subplate, the total components required must be increased accordingly.
4. Use the "Fixture Plate and Vise Quote Form" to assist in selecting the required fixture plates and ball lock shanks required for mounting.
 - a. This form lists the ball lock shanks and part number for each subplate selected.

As always, please do not hesitate to contact Jergens Workholding Solutions for engineering assistance.

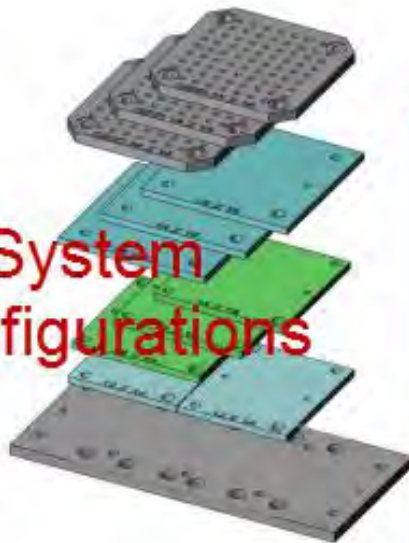
The Ball Lock® Configurator Tool

Jergens Workholding Solution group also has an On-Line Configurator Tool called the Ball Lock® Wizard. This tool allows the user to create a configured system of subplates, fixture plates and vises to design a quick change system that will work for your machine tool make and model. The on line program is available on:

<http://www.jergensinc.com> OR <http://jergens.configurators.com/ext/Login>

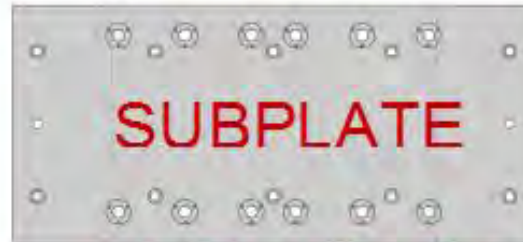


System Configurations



Subplate Size

35.4 X 16.1 X 1.125



subplate part number



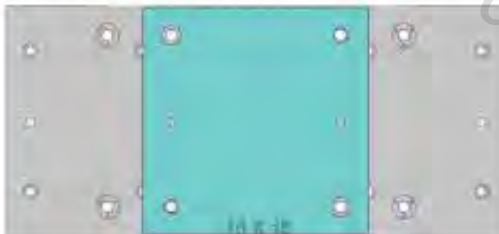
Optional Fixture Plates Choose Aluminum or Steel

☐ 28711 Aluminum

☐ 28811 Steel

☐ 28713 Aluminum

☐ 28813 Steel



☐ 28715 Aluminum

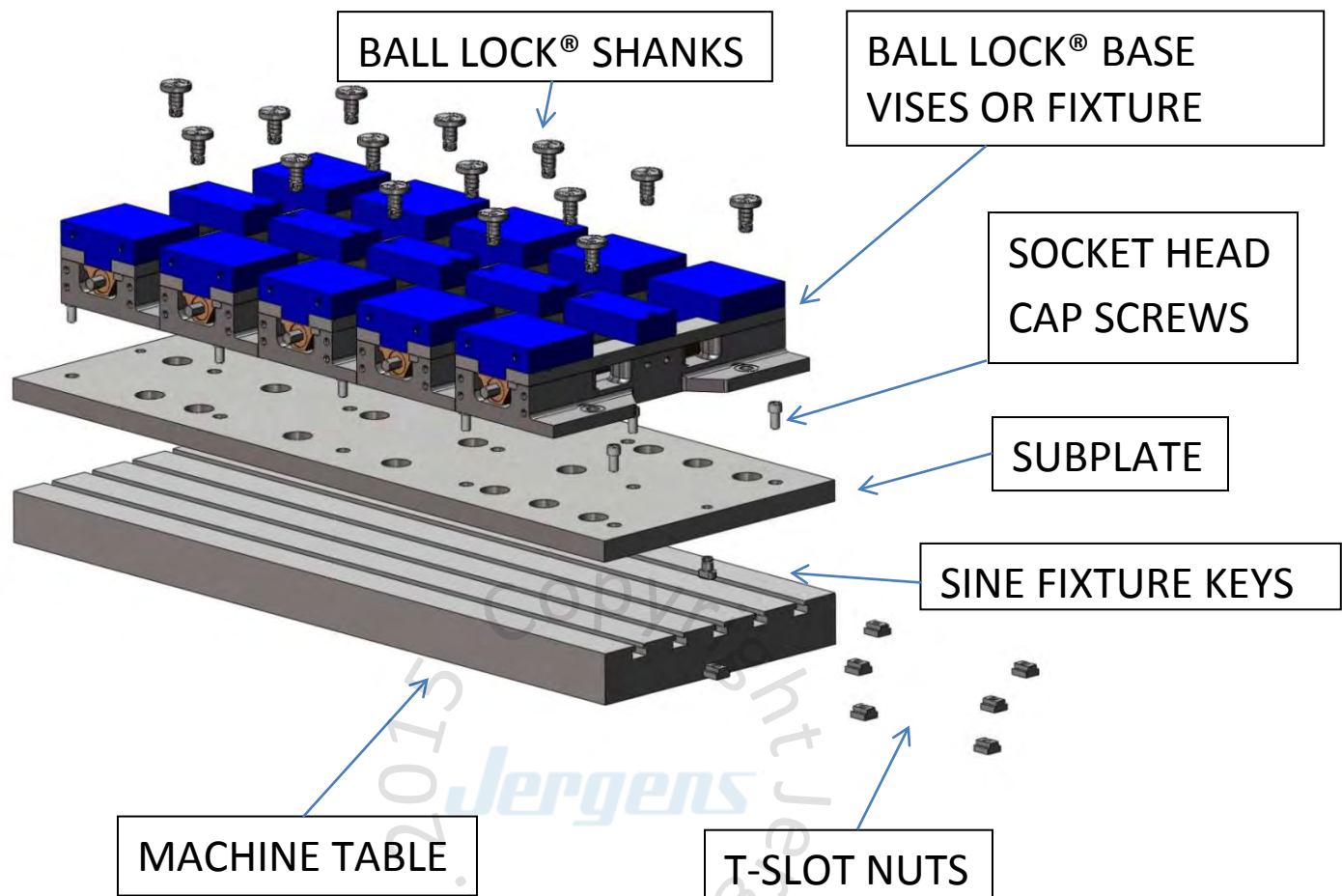
☐ 28815 Steel



☐ 28801 Steel



How the Ball Lock® Mounting System Works



MACHINE TABLES - come in various sizes, t-slot sizes, number of t-slots and also drilled & tapped configurations.

SUBPLATES - can be made to suit your needs in addressing your manufacturing quick-change requirements.

SINE FIXTURE KEYS - are used to align the subplate to a t-slotted table during the installation of the subplate to your machine table.

T-SLOT NUTS - are used in the fastening of the subplate to the machine table.

SOCKET HEAD CAP SCREW'S - are installed thru the subplate and into the t-slot nuts to lock down the subplate to the machine table.

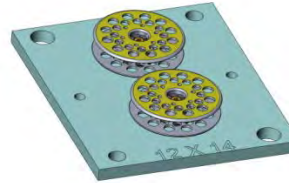
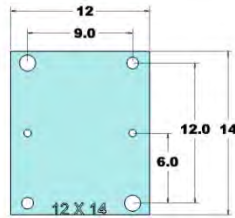
BALL LOCK® BASE VISES OR FIXTURE PLATES - allow you to change out your vises or fixture in minutes within +/- .0005 repeatability versus hours of set-up and indicating in the vise or fixture.

BALL LOCK® SHANKS - are used to locate and lock the vises or fixtures to the receiver bushings installed in the subplate with 2-1/2 turns to lock or release with low torque and high clamping forces.

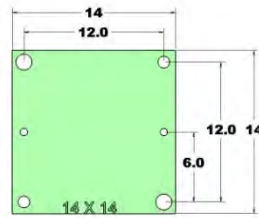
FIXTURE PLATES

Shown below are color coded Fixture Plates to assist in determining the various subplate options to best suit your manufacturing quick change requirements.

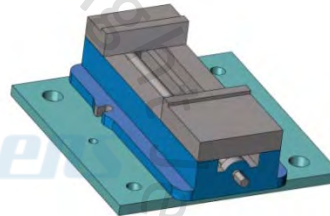
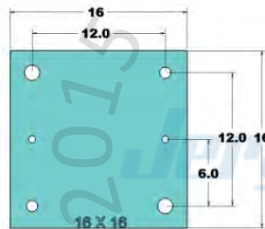
28711(ALUM)/28811(STEEL)



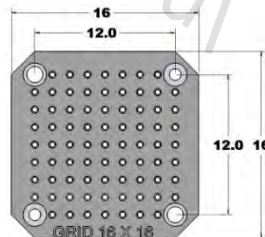
28713(ALUM)/28813(STEEL)



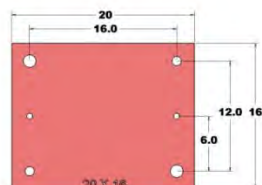
28715(ALUM)/28815(STEEL)



28801(STEEL)



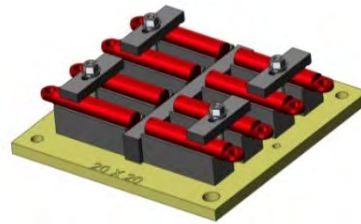
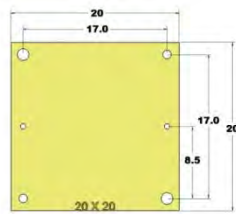
28719(ALUM)/28819(STEEL)



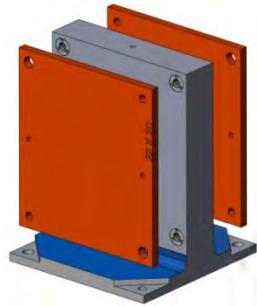
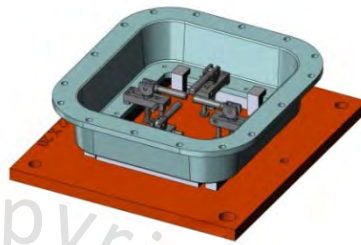
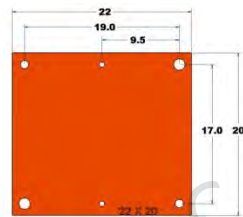
FIXTURE PLATES

Shown below are color coded Fixture Plates to assist in determining the various subplate options to best suit your manufacturing quick change requirements.

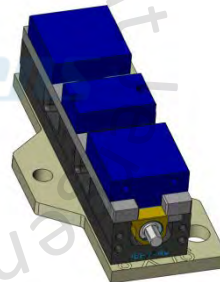
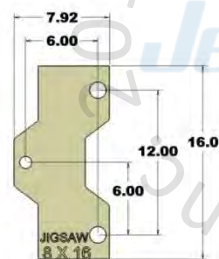
28727(ALUM)/28827(STEEL)



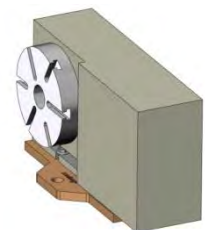
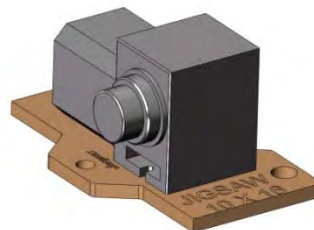
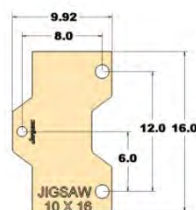
28745(ALUM)/28845(STEEL)



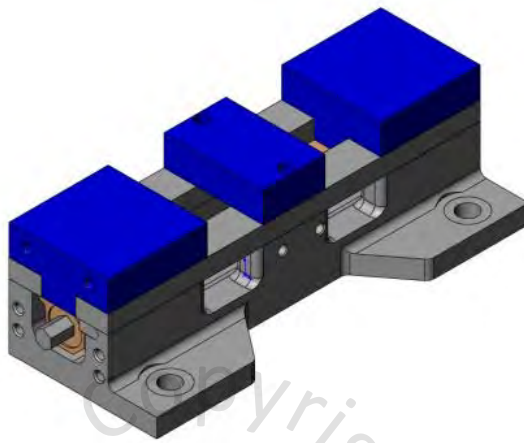
28705(ALUM)/28805(STEEL)



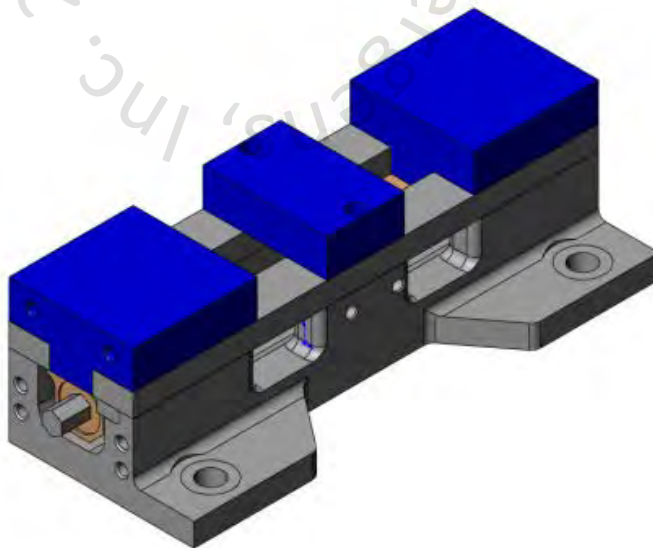
28706(ALUM)/28806(STEEL)



BALL LOCK® BASE VISES- shown below are color coded Vises to assist in determining the various subplate options to best suit your manufacturing quick change requirements.



49405(4" VISE BALL LOCK® BASE)



49406(6" VISE BALL LOCK® BASE)

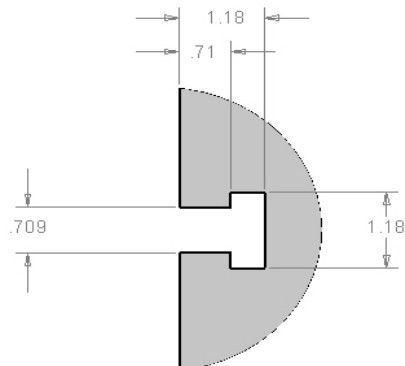
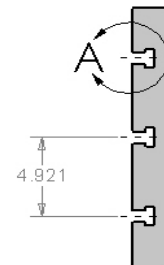
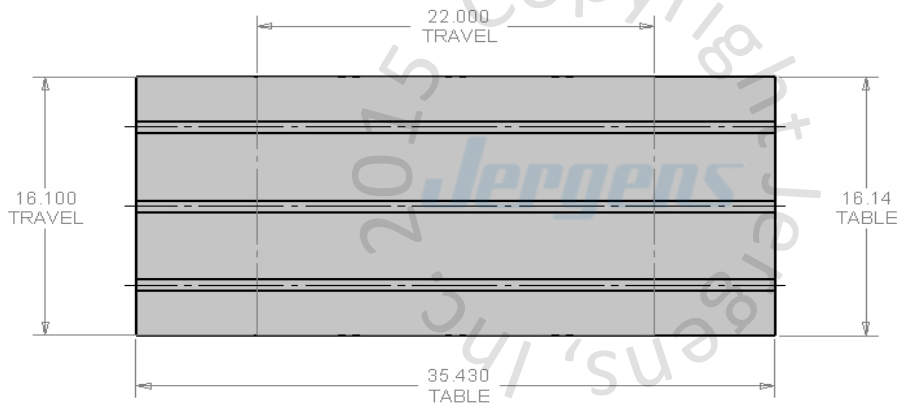


NEXUS 410A



Table Specifications

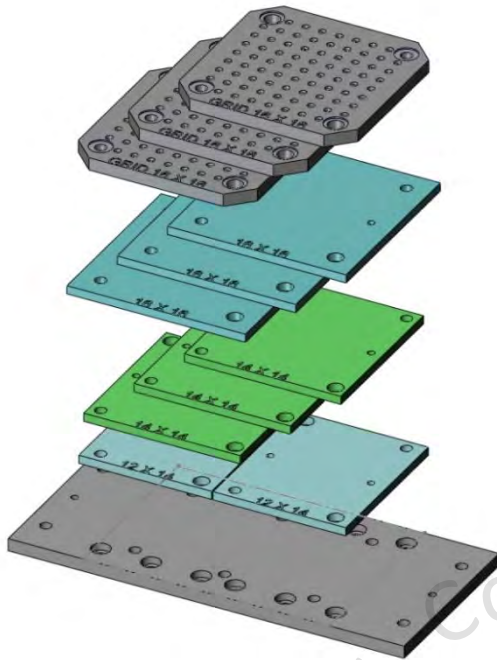
- Table Travel (X, Y, Z): 22.0" x 16.1" x 20.08"
- Table Dimensions (L x W): 35.43" x 16.14"
- Maximum Weight on Table: 1100 lbs
- T-Slot Width: .709" (18mm)
- T-Slot Center Distance: 4.921" (125mm)



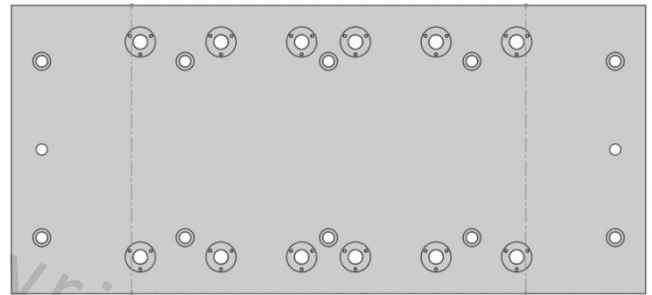
T-SLOT
DETAIL
A



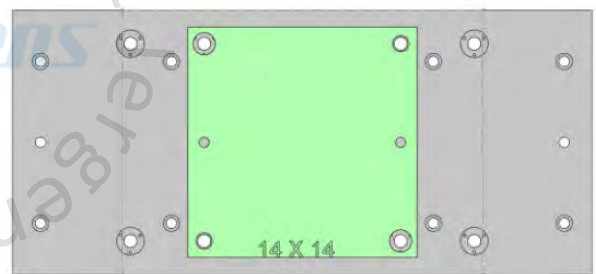
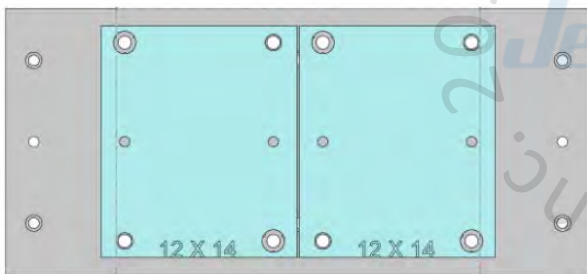
VCN410A-001



35.4 X 16.1 X 1.125

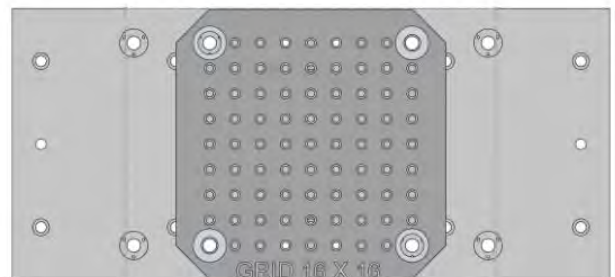
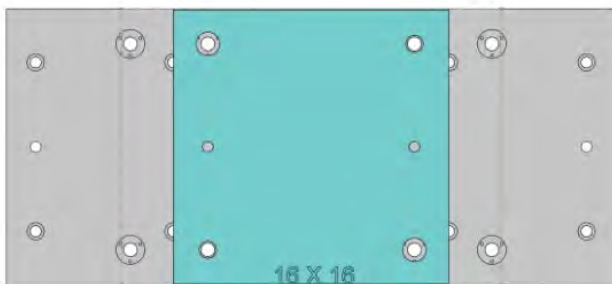


☐ VCN410A-001



☐ 28711 Aluminum ☐ 28811 Steel

☐ 28713 Aluminum ☐ 28813 Steel

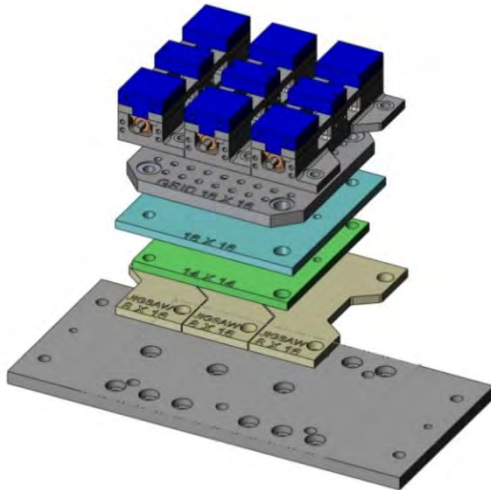


☐ 28715 Aluminum ☐ 28815 Steel

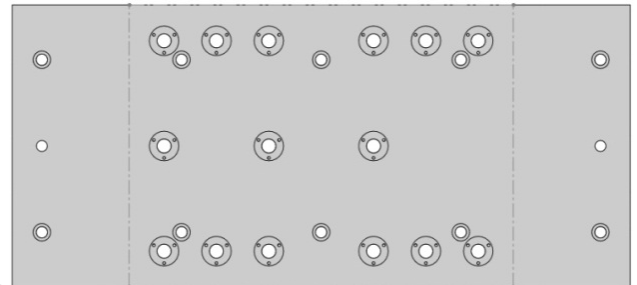
☐ 28801 Steel



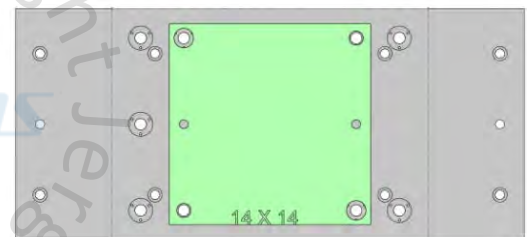
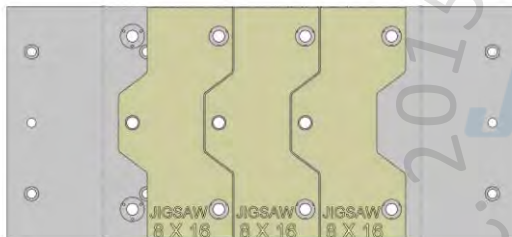
VCN410A-002



35.4 X 16.1 X 1.125



☐ VCN410A-002

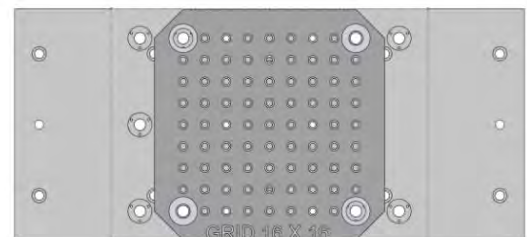
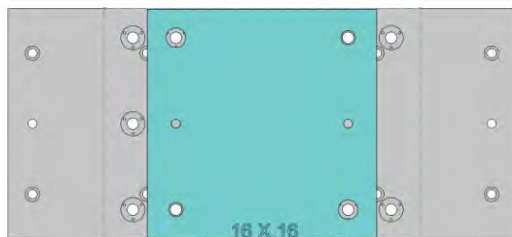


☐ 28705 Aluminum

☐ 28805 Steel

☐ 28713 Aluminum

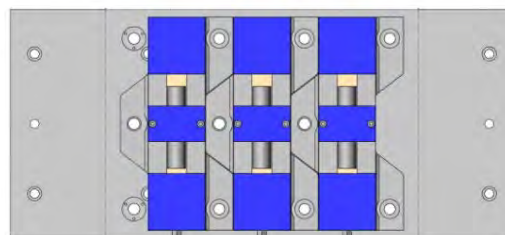
☐ 28813 Steel



☐ 28715 Aluminum

☐ 28815 Steel

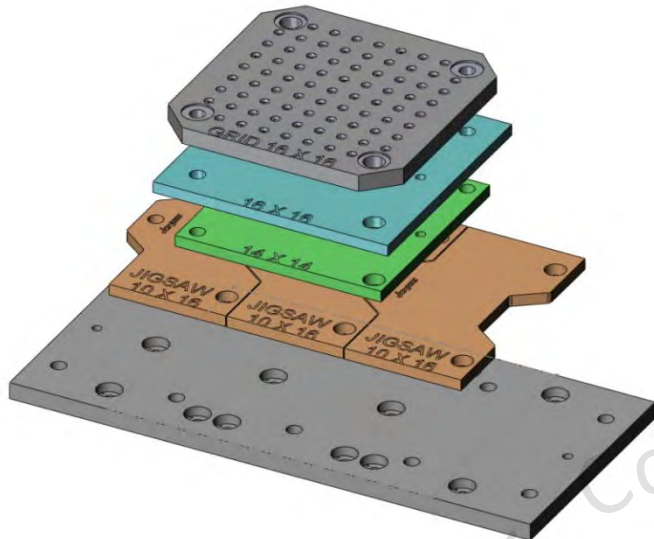
☐ 28801 Steel



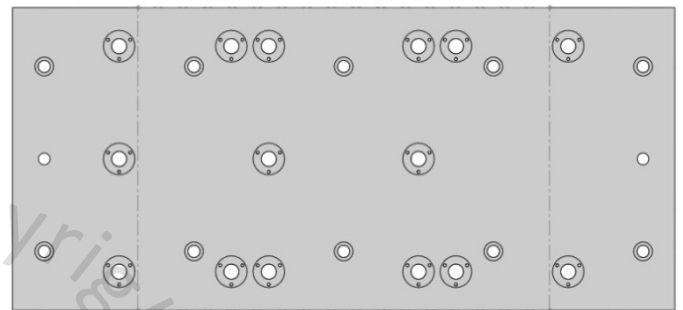
☐ 49405 4" Vise Ball Lock® Base



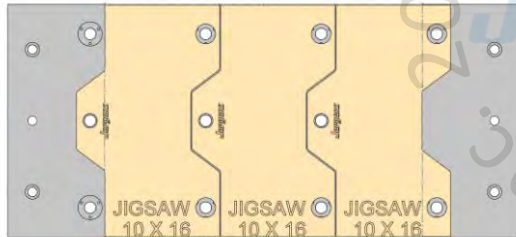
VCN410A-003



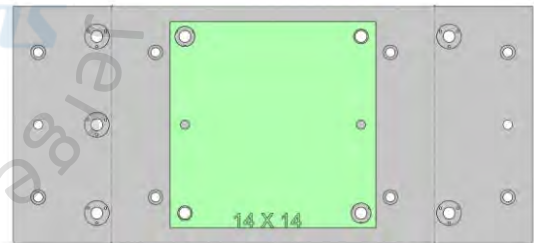
35.4 X 16.1 X 1.125



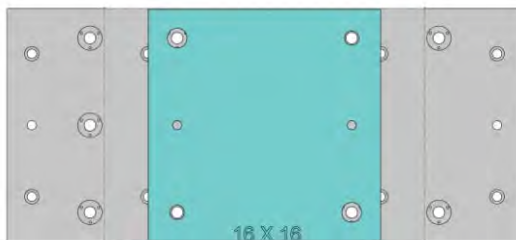
☐ VCN410A-003



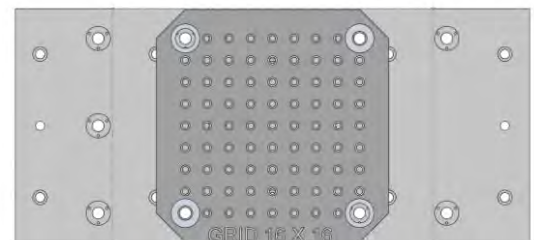
☐ 28706 Aluminum ☐ 28806 Steel



☐ 28713 Aluminum ☐ 28813 Steel



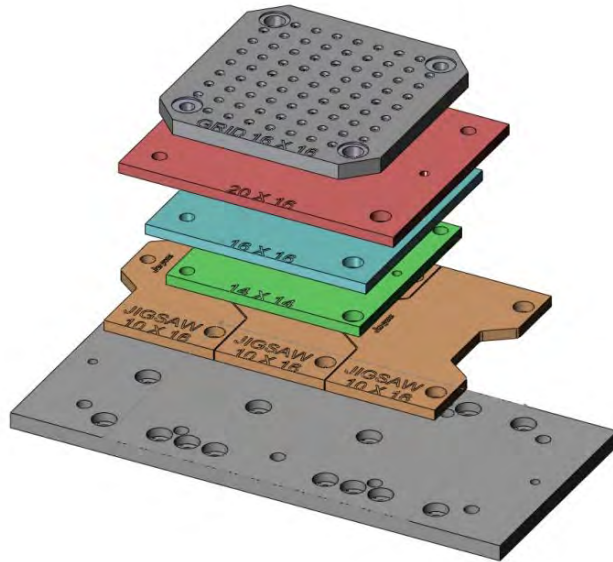
☐ 28715 Aluminum ☐ 28815 Steel



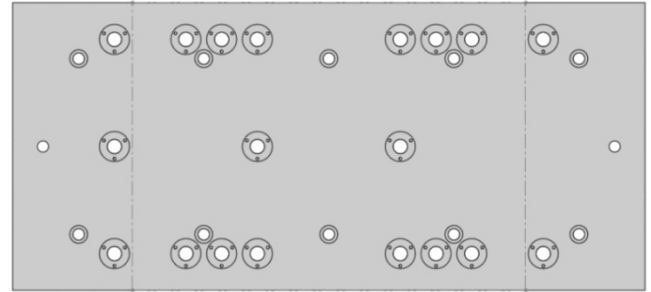
☐ 28801 Steel



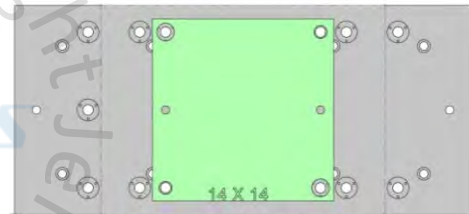
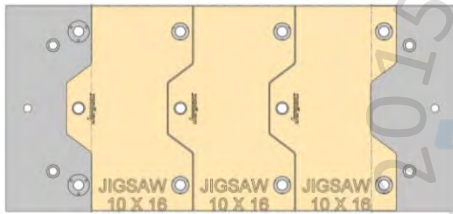
VCN410A-004



35.4 X 16.1 X 1.125



☐ VCN410A-004

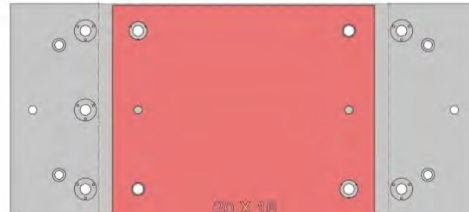
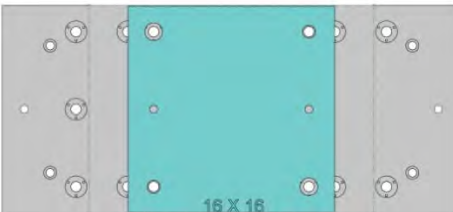


☐ 28706 Aluminum

☐ 28806 Steel

☐ 28713 Aluminum

☐ 28813 Steel

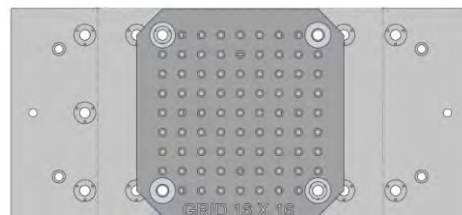


☐ 28715 Aluminum

☐ 28815 Steel

☐ 28719 Aluminum

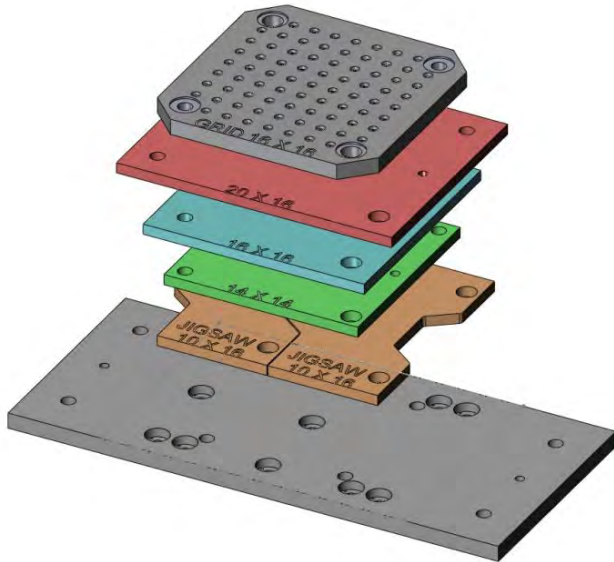
☐ 28819 Steel



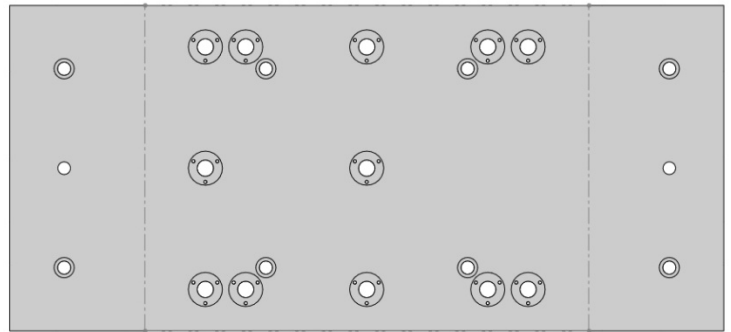
☐ 28801 Steel



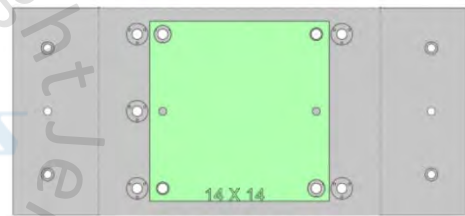
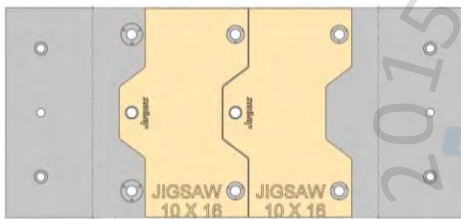
VCN410A-005



35.4 X 16.1 X 1.125



☐ VCN410A-005

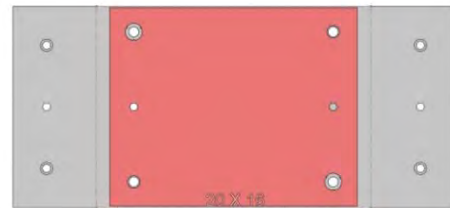
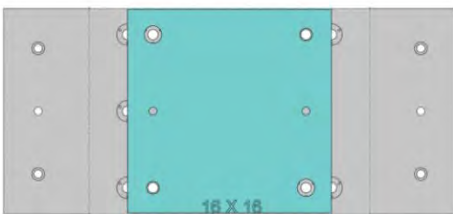


☐ 28706 Aluminum

☐ 28806 Steel

☐ 28713 Aluminum

☐ 28813 Steel

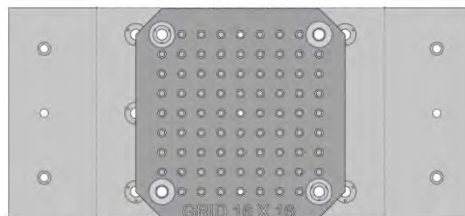


☐ 28715 Aluminum

☐ 28815 Steel

☐ 28719 Aluminum

☐ 28819 Steel



☐ 28801 Steel

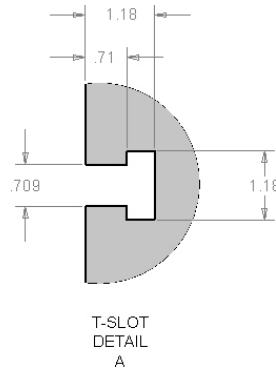
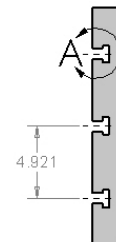
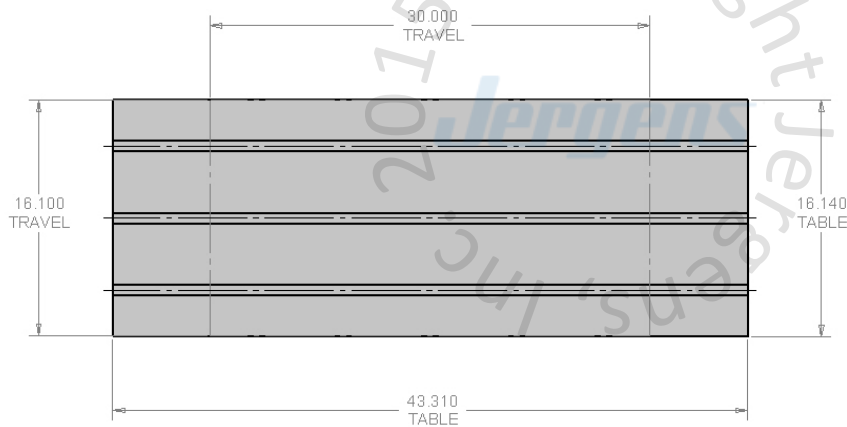


NEXUS 410B



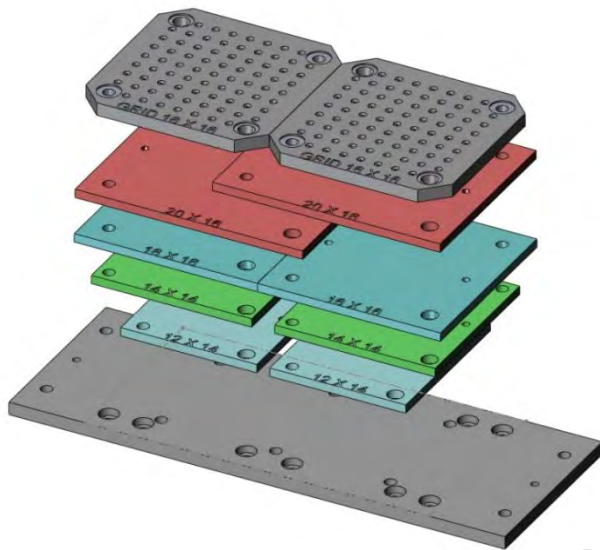
Table Specifications

- Table Travel (X, Y, Z): 30.0" x 16.1" x 20.08"
- Table Dimensions (L x W): 43.3" x 16.1"
- Maximum Weight on Table: 1540 lbs
- T-Slot Width: .709" (18mm)
- T-Slot Center Distance: 4.921" (125mm)

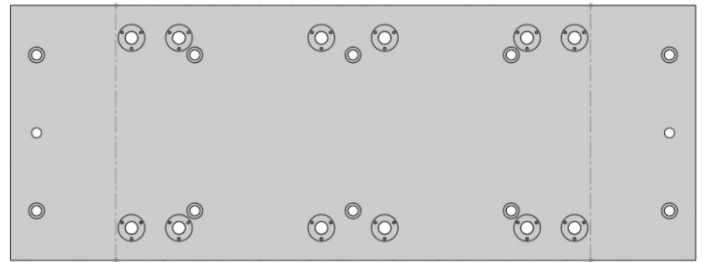




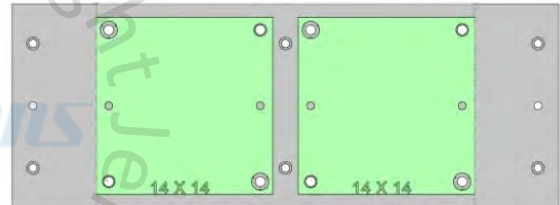
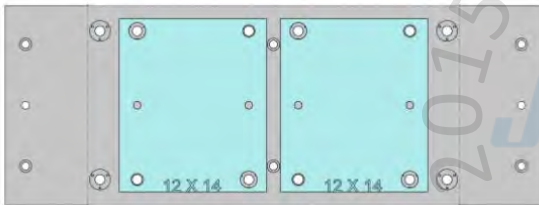
VCN410B-001



43.3 X 16.1 X 1.125



☐ VCN410B-001

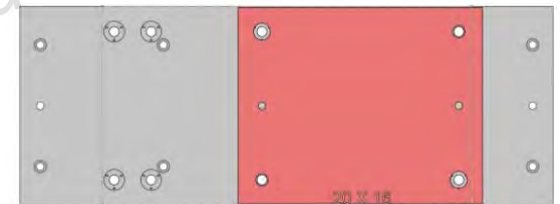
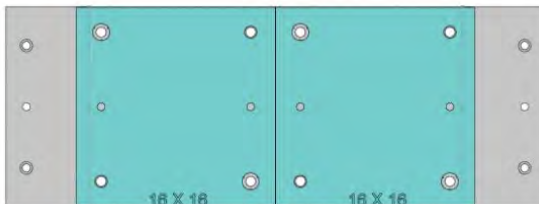


☐ 28711 Aluminum

☐ 28811 Steel

☐ 28713 Aluminum

☐ 28813 Steel

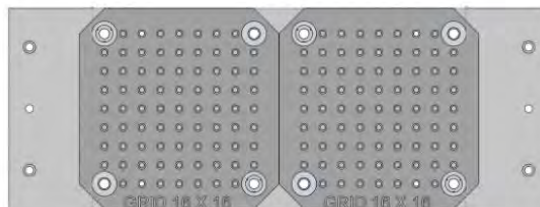


☐ 28715 Aluminum

☐ 28815 Steel

☐ 28719 Aluminum

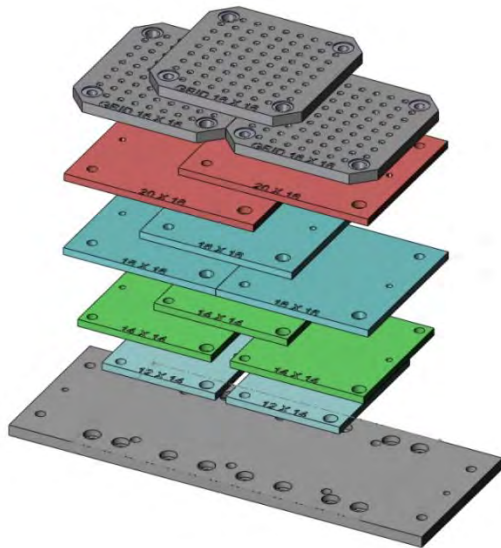
☐ 28819 Steel



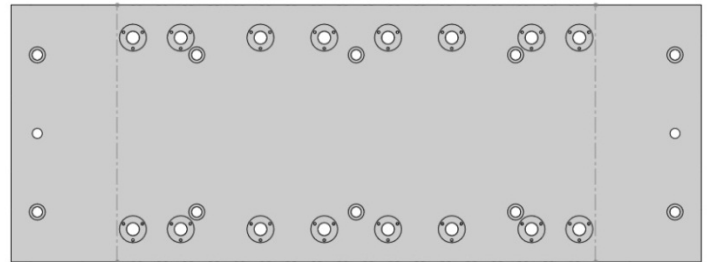
☐ 28801 Steel



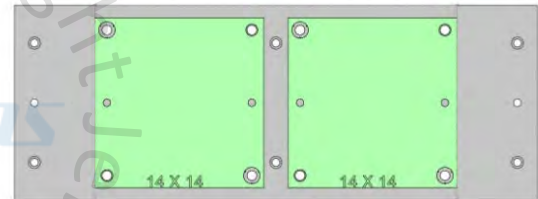
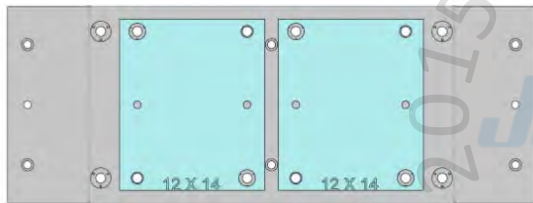
VCN410B-002



43.3 X 16.1 X 1.125

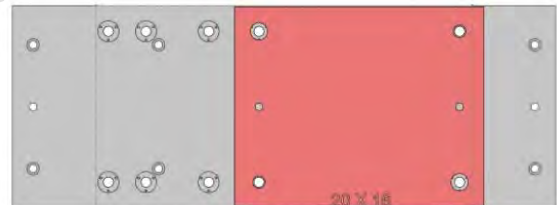
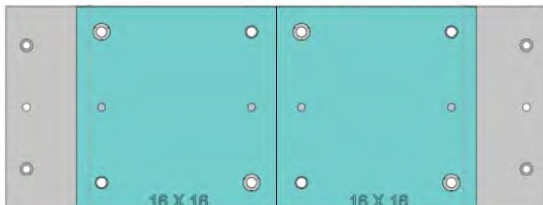


☐ VCN410B-002



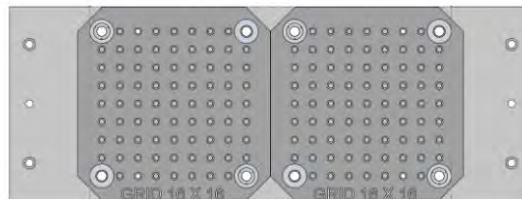
☐ 28711 Aluminum ☐ 28811 Steel

☐ 28713 Aluminum ☐ 28813 Steel



☐ 28715 Aluminum ☐ 28815 Steel

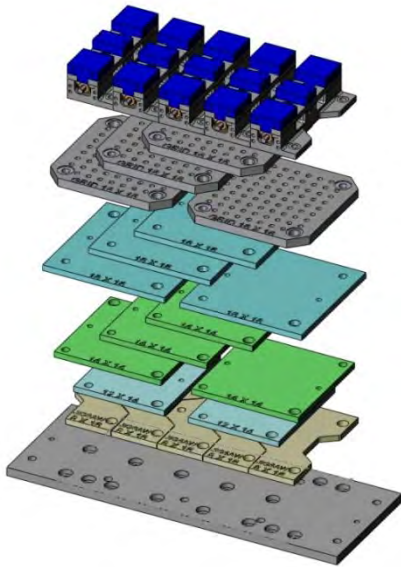
☐ 28719 Aluminum ☐ 28819 Steel



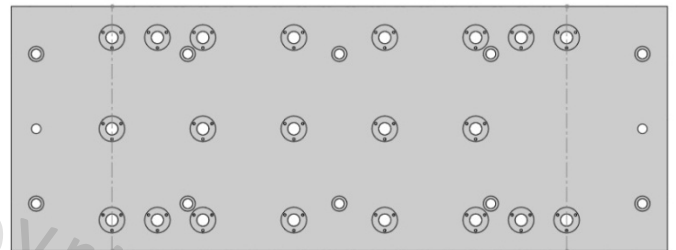
☐ 28801 Steel



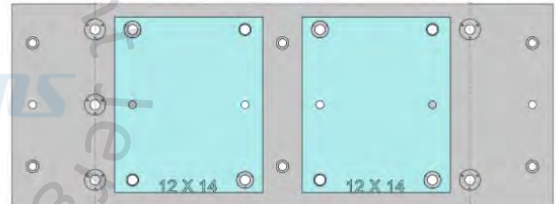
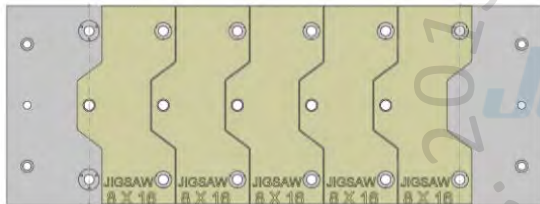
VCN410B-003



43.3 X 16.1 X 1.125



☐ VCN410B-003

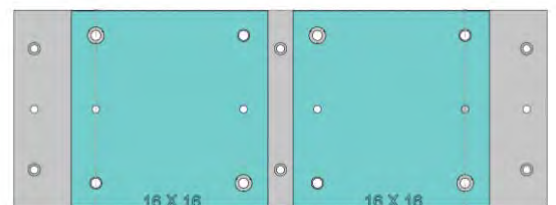
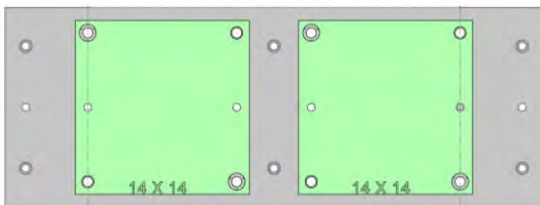


☐ 28705 Aluminum

☐ 28805 Steel

☐ 28711 Aluminum

☐ 28811 Steel

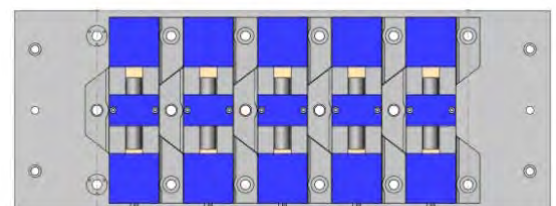
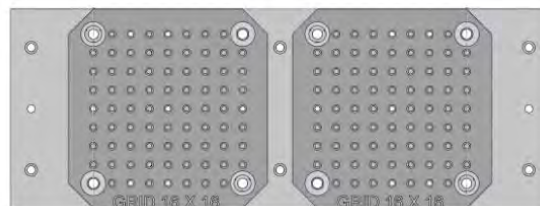


☐ 28713 Aluminum

☐ 28813 Steel

☐ 28715 Aluminum

☐ 28815 Steel

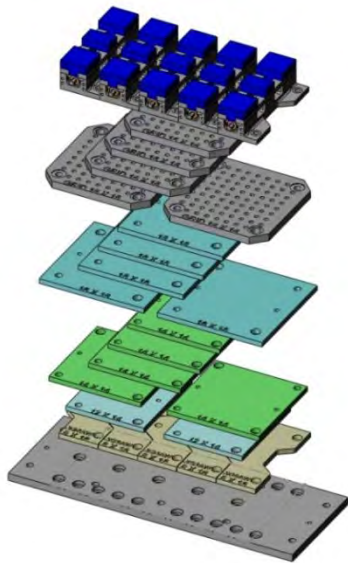


☐ 28801 Steel

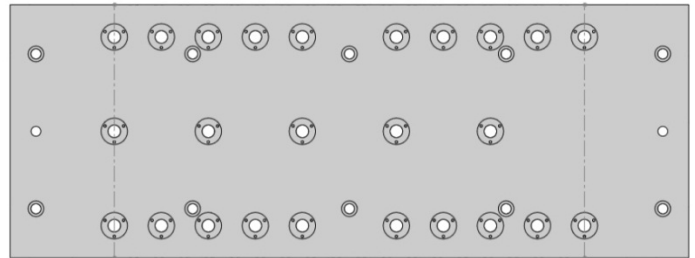
☐ 49405 4" Vise Ball Lock® Base



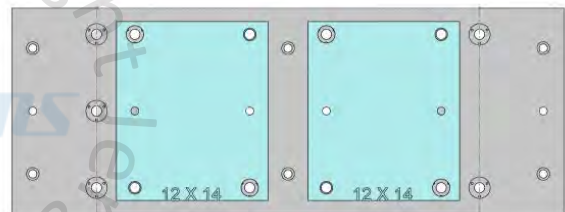
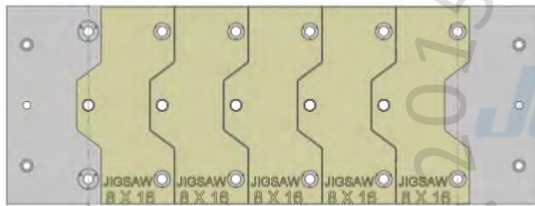
VCN410B-004



43.3 X 16.1 X 1.125



☐ VCN410B-004

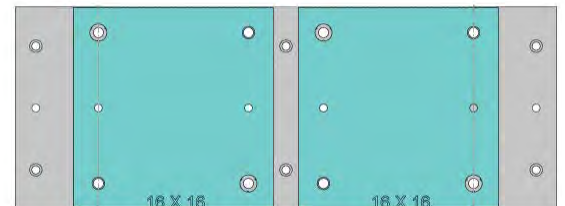
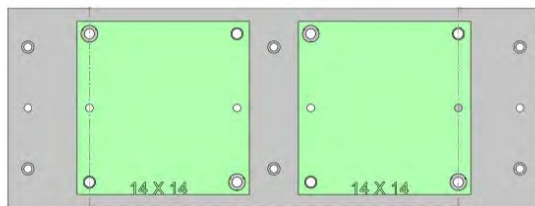


☐ 28705 Aluminum

☐ 28805 Steel

☐ 28711 Aluminum

☐ 28811 Steel

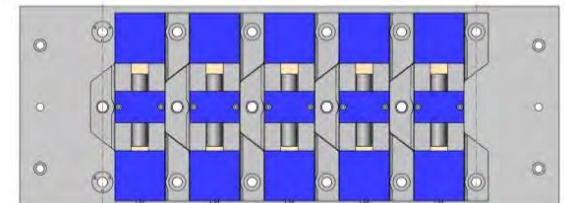
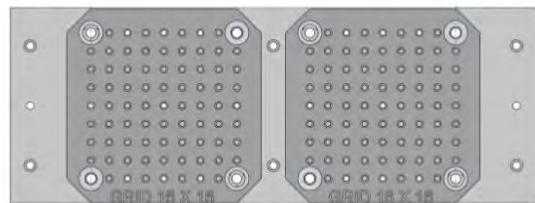


☐ 28713 Aluminum

☐ 28813 Steel

☐ 28715 Aluminum

☐ 28815 Steel

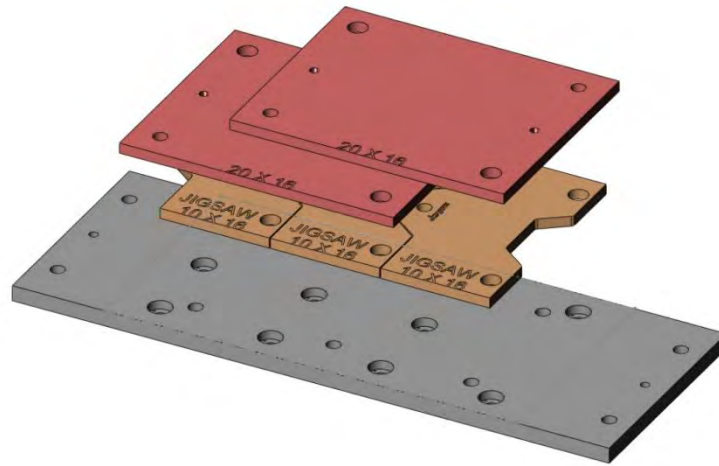


☐ 28801 Steel

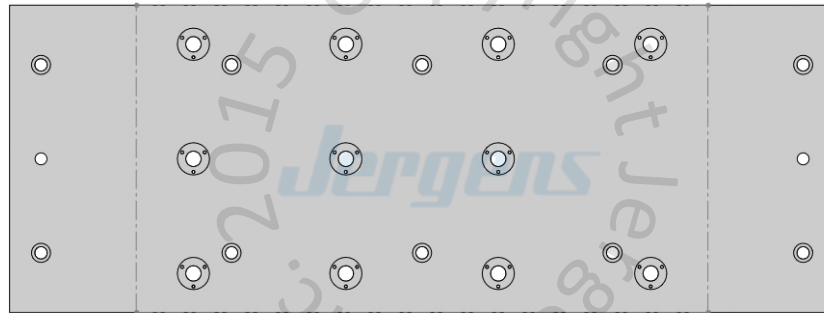
☐ 49405 4" Vise Ball Lock® Base



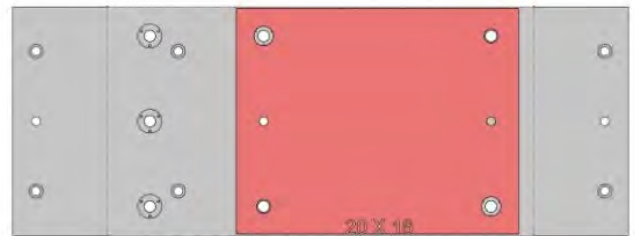
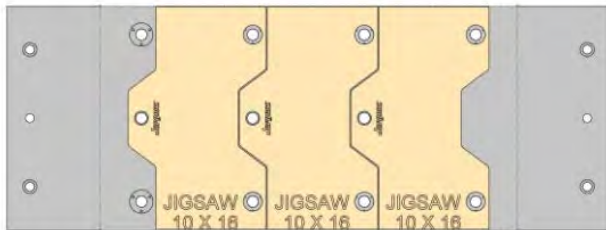
VCN410B-005



43.3 X 16.1 X 1.125



☐ VCN410B-005

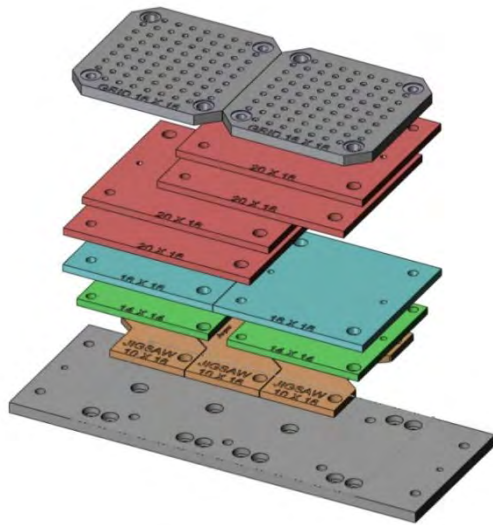


☐ 28706 Aluminum ☐ 28806 Steel

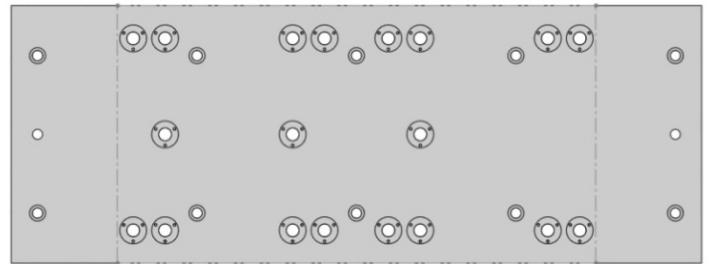
☐ 28719 Aluminum ☐ 28819 Steel



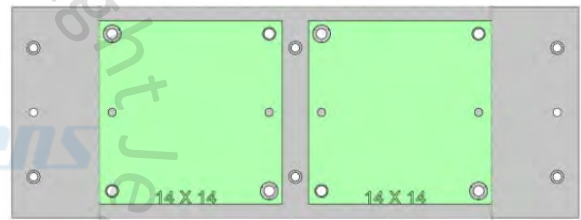
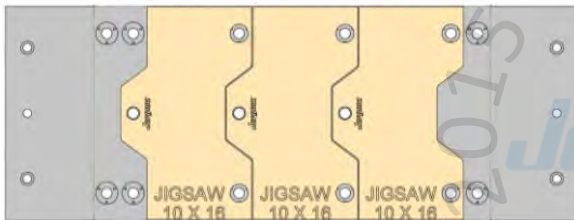
VCN410B-006



43.3 X 16.1 X 1.125



☐ VCN410B-006

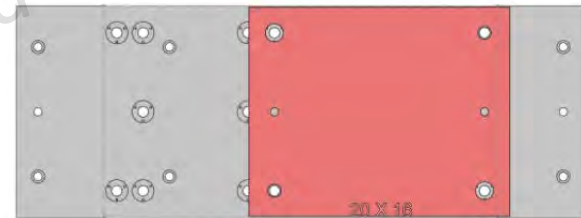
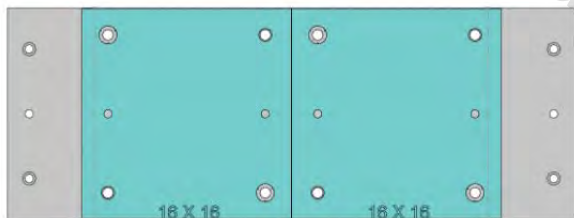


☐ 28706 Aluminum

☐ 28806 Steel

☐ 28713 Aluminum

☐ 28813 Steel

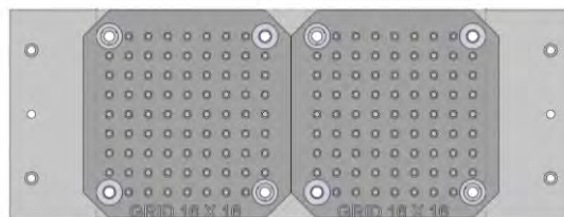


☐ 28715 Aluminum

☐ 28815 Steel

☐ 28719 Aluminum

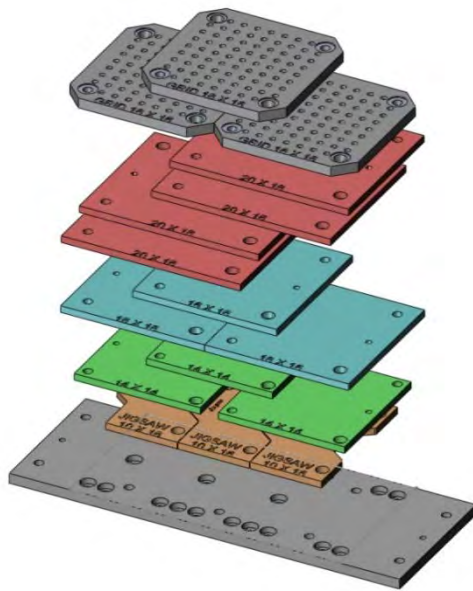
☐ 28819 Steel



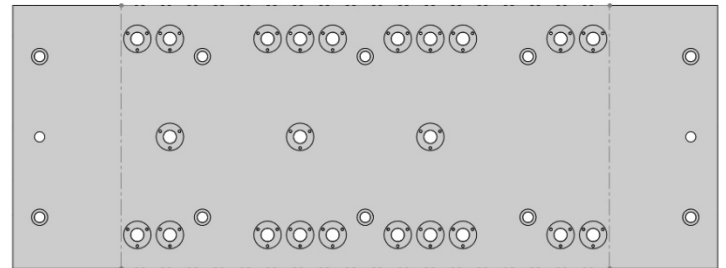
☐ 28801 Steel



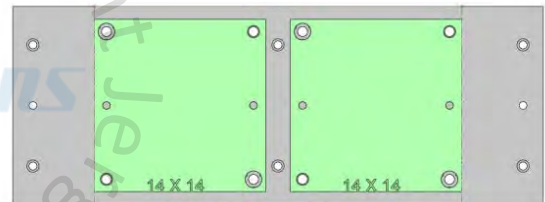
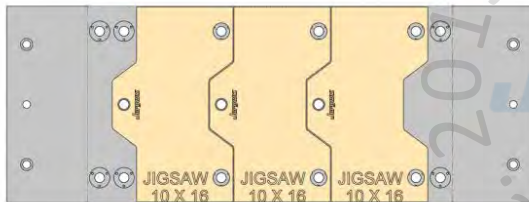
VCN410B-007



43.3 X 16.1 X 1.125



☐ VCN410B-007

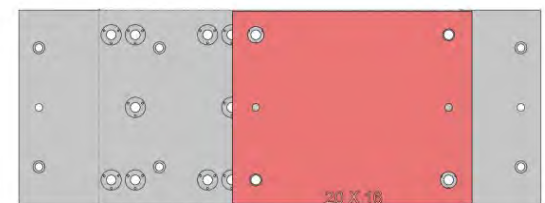
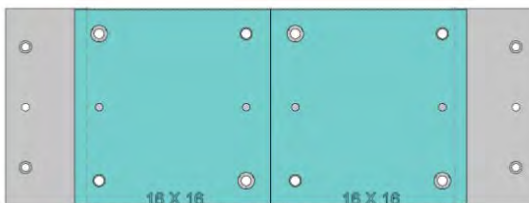


☐ 28706 Aluminum

☐ 28806 Steel

☐ 28713 Aluminum

☐ 28813 Steel

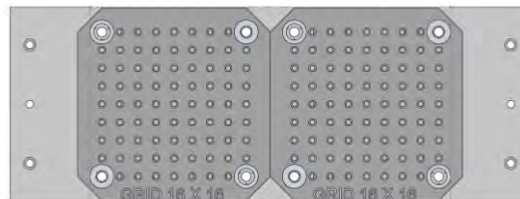


☐ 28715 Aluminum

☐ 28815 Steel

☐ 28719 Aluminum

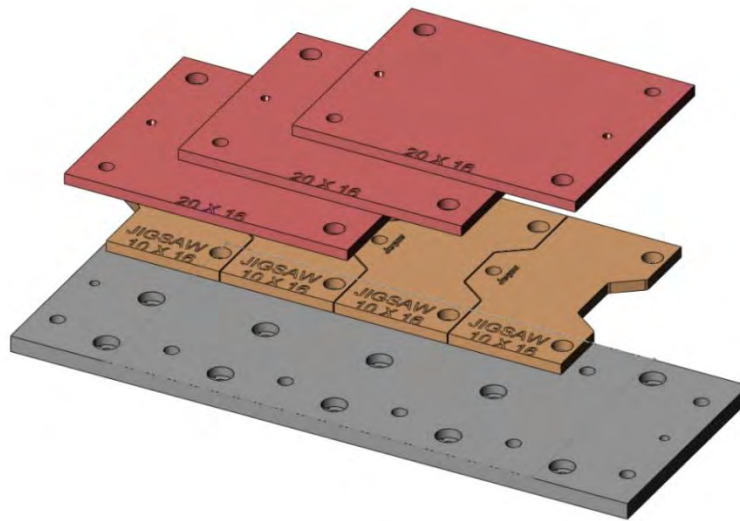
☐ 28819 Steel



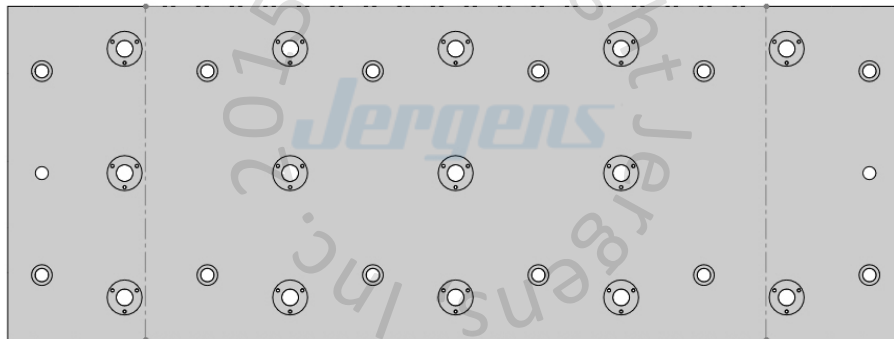
☐ 28801 Steel



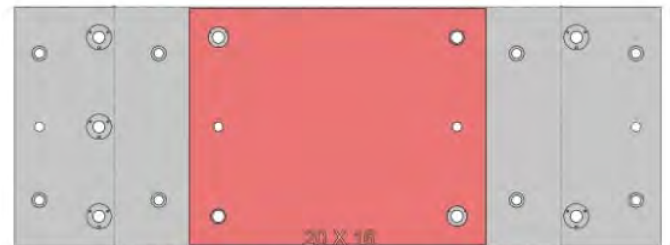
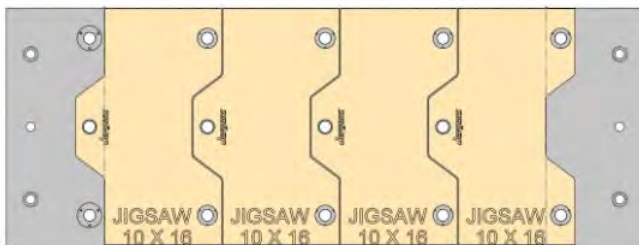
VCN410B-008



43.3 X 16.1 X 1.125



☐ VCN410B-008



☐ 28706 Aluminum

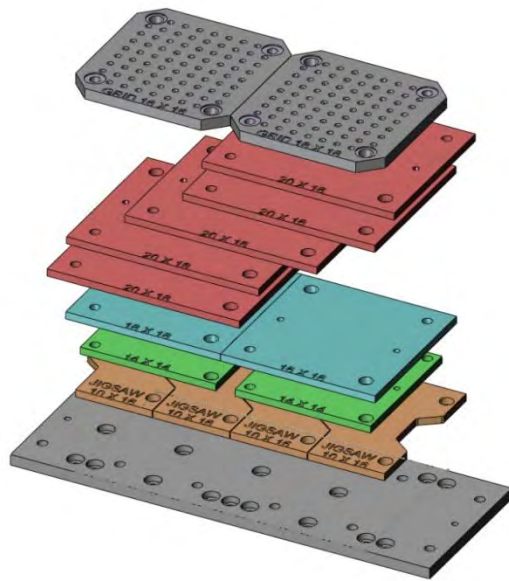
☐ 28806 Steel

☐ 28719 Aluminum

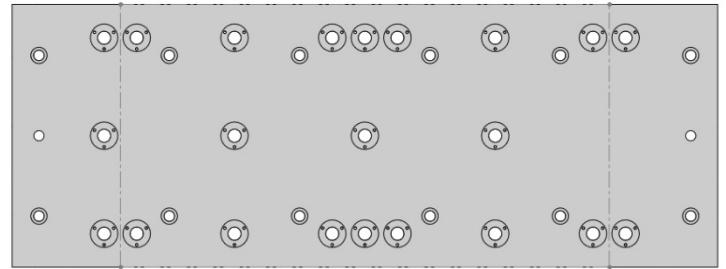
☐ 28819 Steel



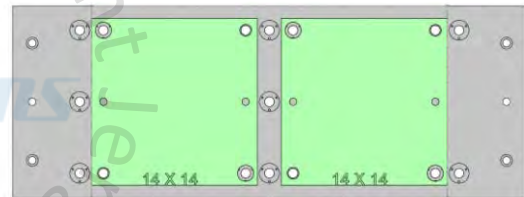
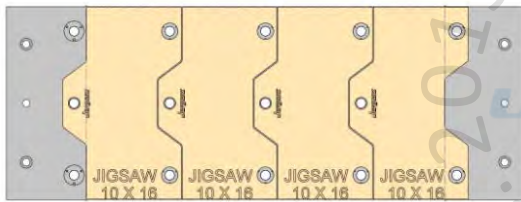
VCN410B-009



43.3 X 16.1 X 1.125



☐ VCN410B-009

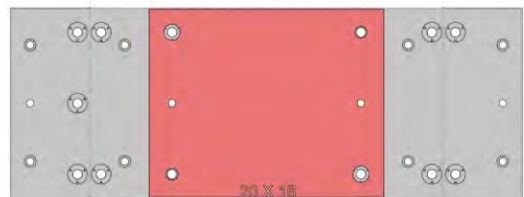
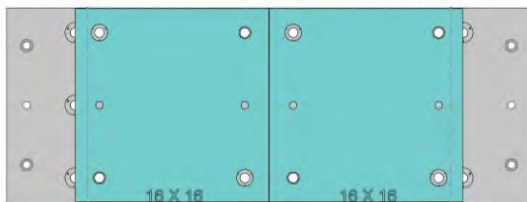


☐ 28706 Aluminum

☐ 28806 Steel

☐ 28713 Aluminum

☐ 28813 Steel

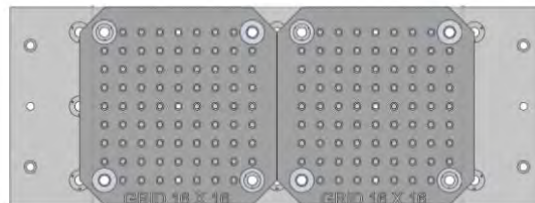


☐ 28715 Aluminum

☐ 28815 Steel

☐ 28719 Aluminum

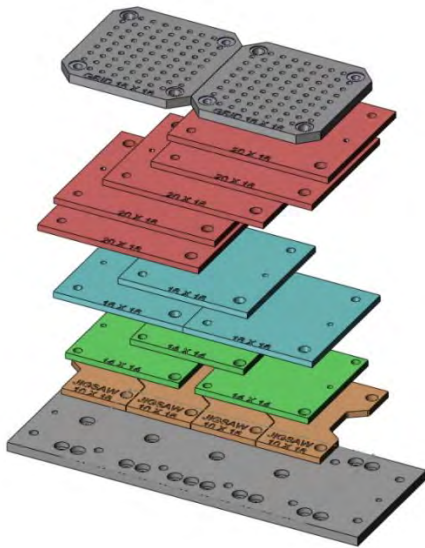
☐ 28819 Steel



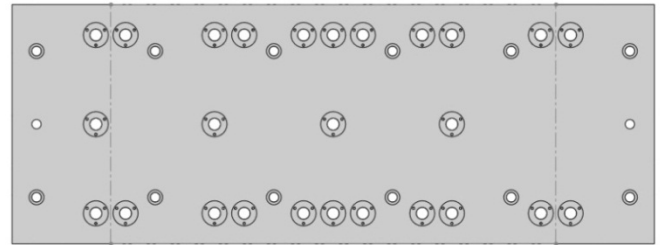
☐ 28801 Steel



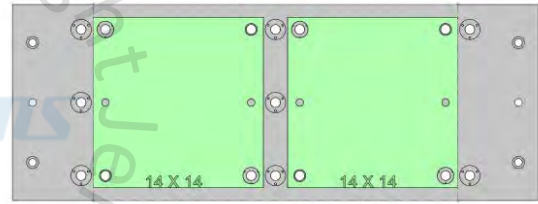
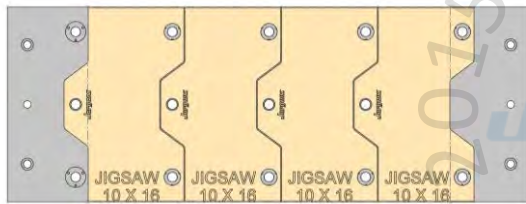
VCN410B-010



43.3 X 16.1 X 1.125



☐ VCN410B-010

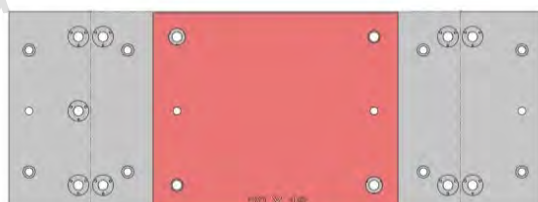
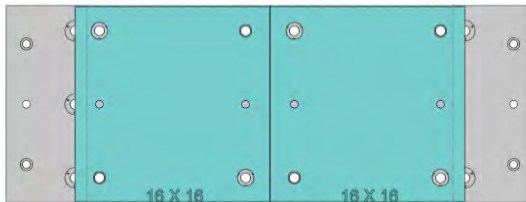


☐ 28706 Aluminum

☐ 28806 Steel

☐ 28713 Aluminum

☐ 28813 Steel

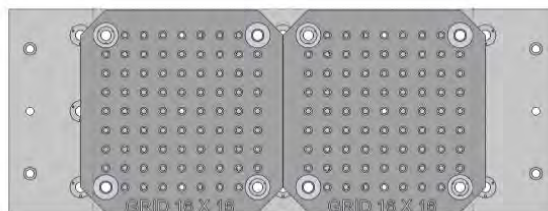


☐ 28715 Aluminum

☐ 28815 Steel

☐ 28719 Aluminum

☐ 28819 Steel



☐ 28801 Steel

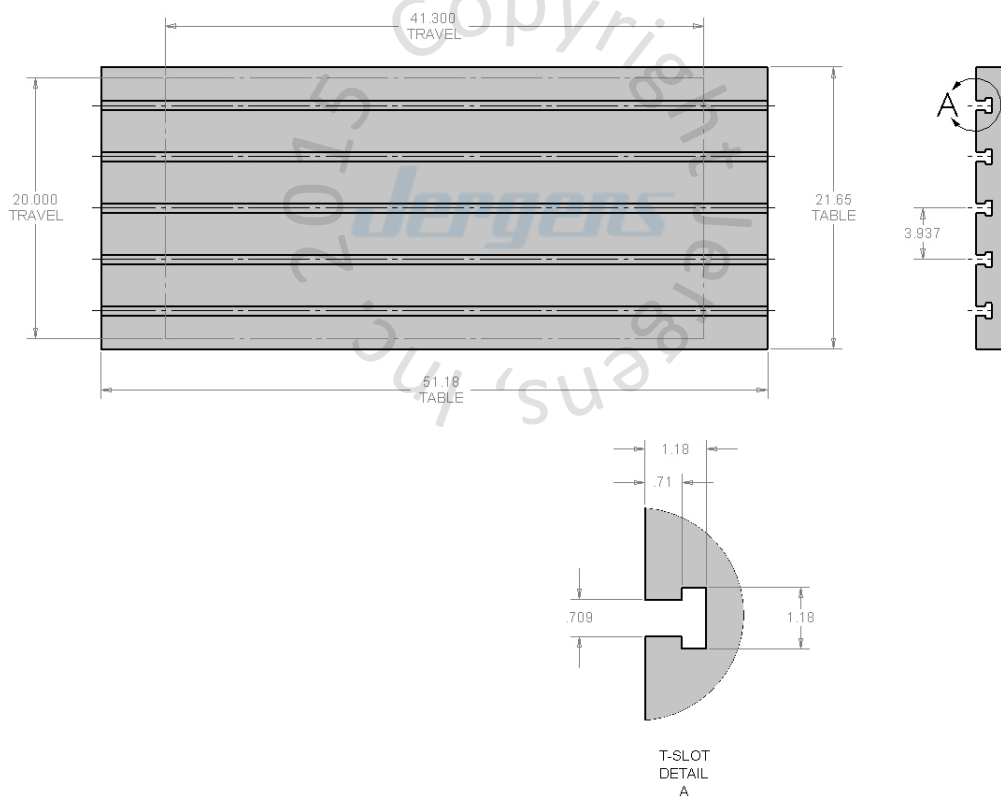


NEXUS 510C



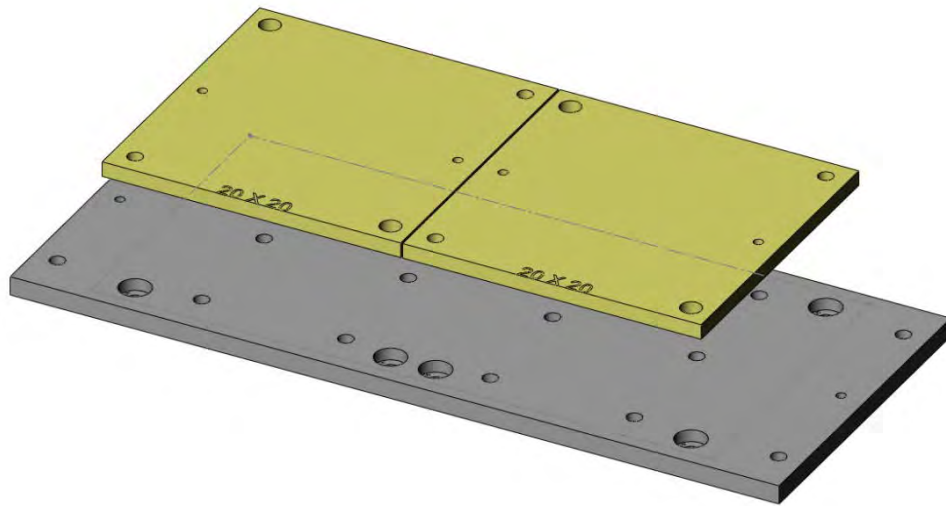
Table Specifications

- Table Travel (X, Y, Z): 41.3" x 20" x 20"
- Table Dimensions (L x W): 51.18" x 21.65"
- Maximum Weight on Table: 2640 lbs
- T-Slot Width: .709" (18mm)
- T-Slot Center Distance: 3.937" (100mm)

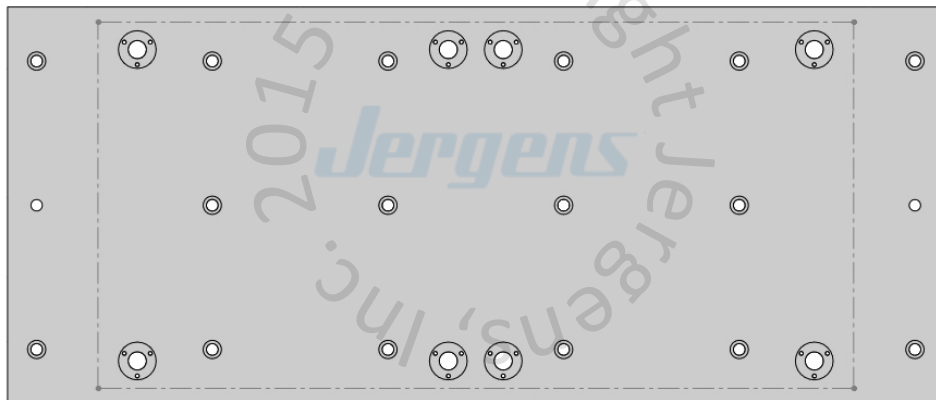




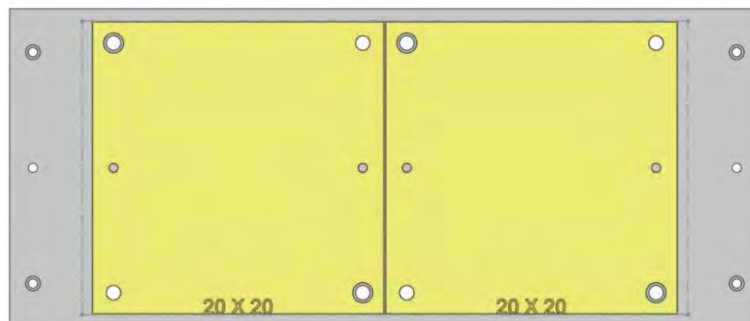
VCN510C-001



51.1 X 21.6 X 1.25



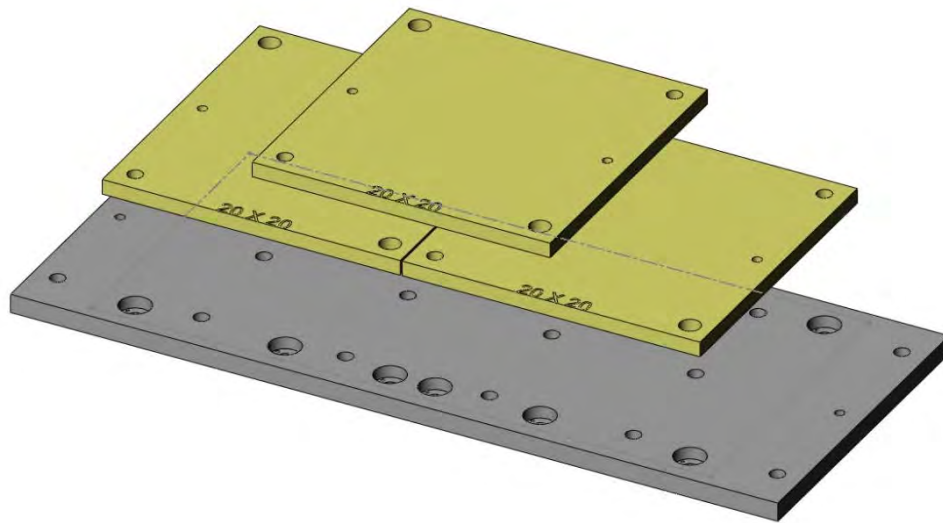
☐ VCN510C-001



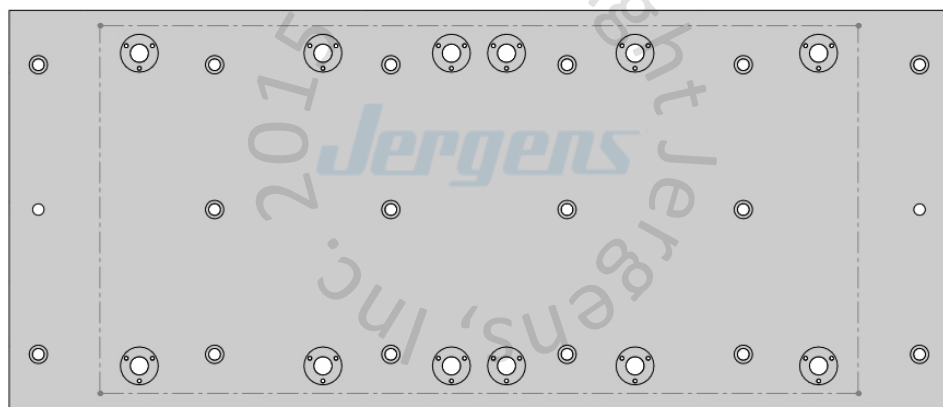
☐ 28727 Aluminum ☐ 28827 Steel



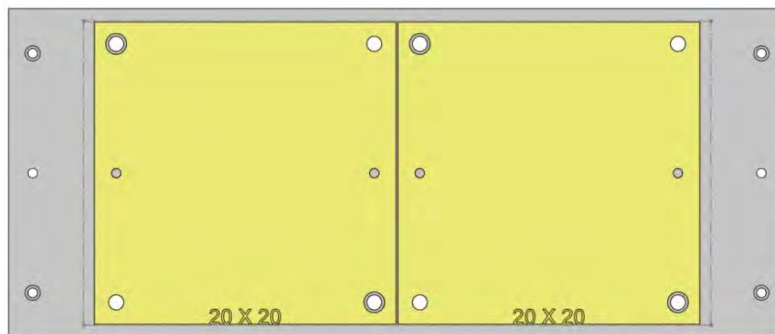
VCN510C-002



51.1 X 21.6 X 1.25



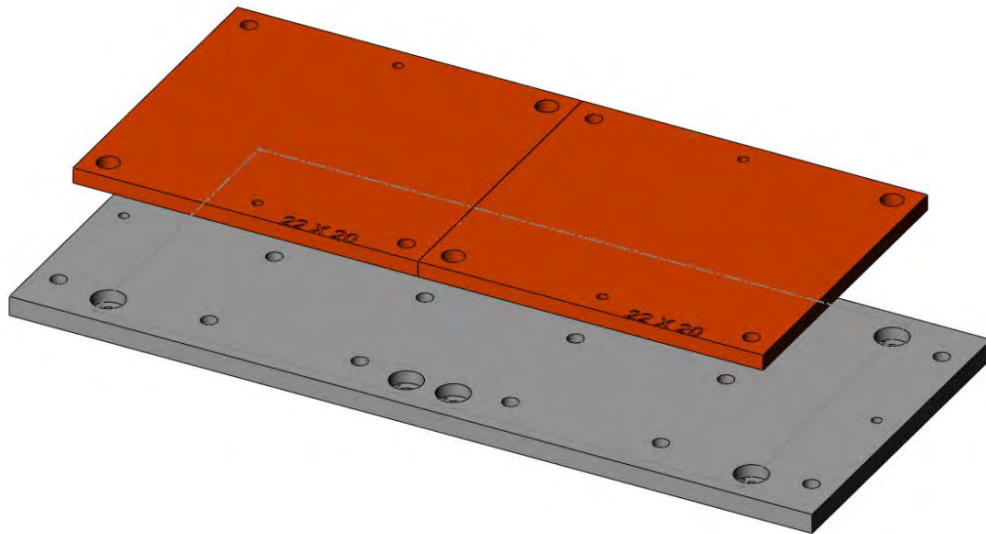
☐ VCN510C-002



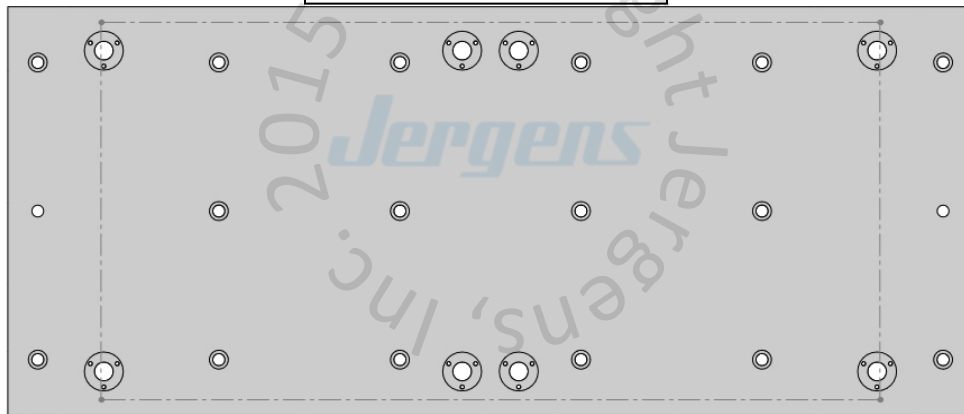
☐ 28727 Aluminum ☐ 28827 Steel



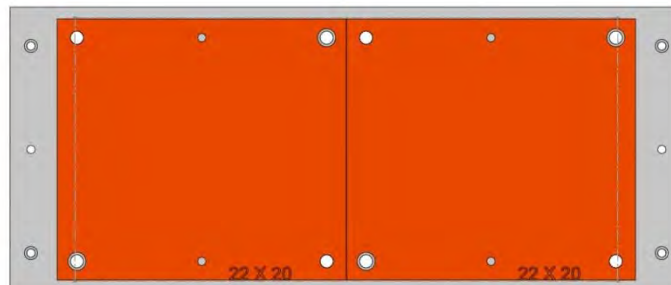
VCN510C-003



51.1 X 21.6 X 1.25



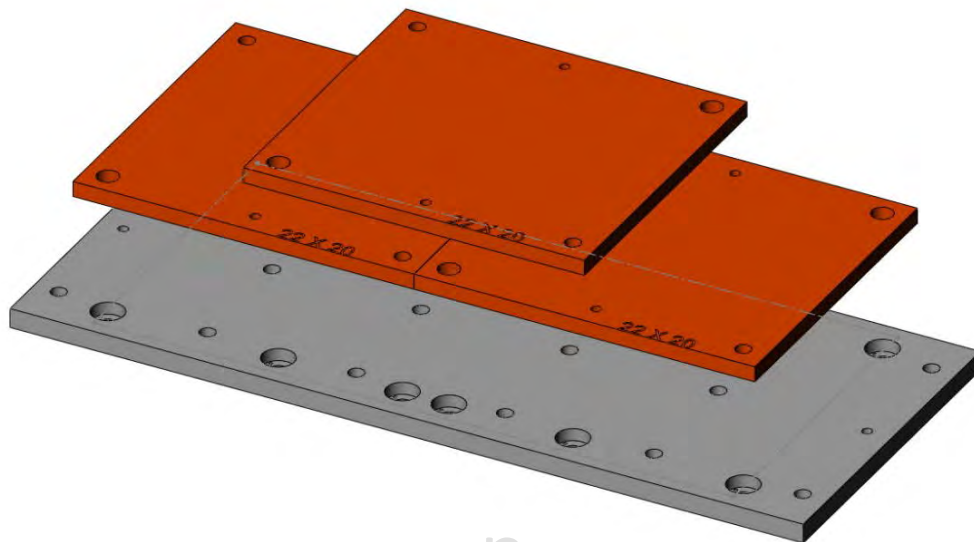
☐ VCN510C-003



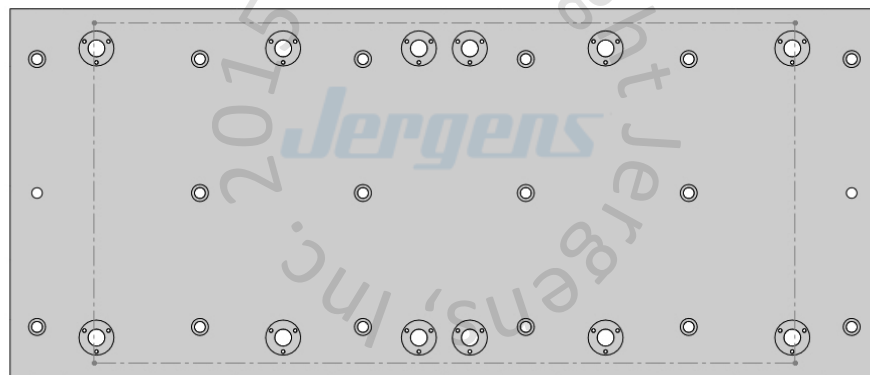
☐ 28745 Aluminum ☐ 28845 Steel



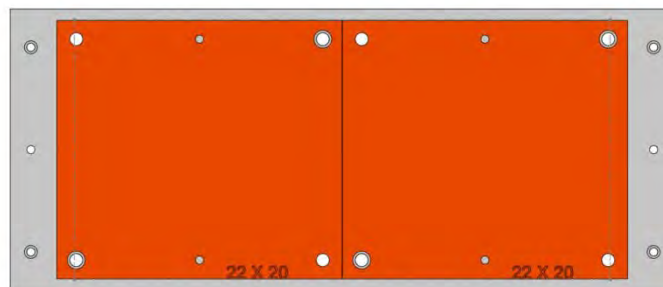
VCN510C-004



51.1 X 21.6 X 1.25



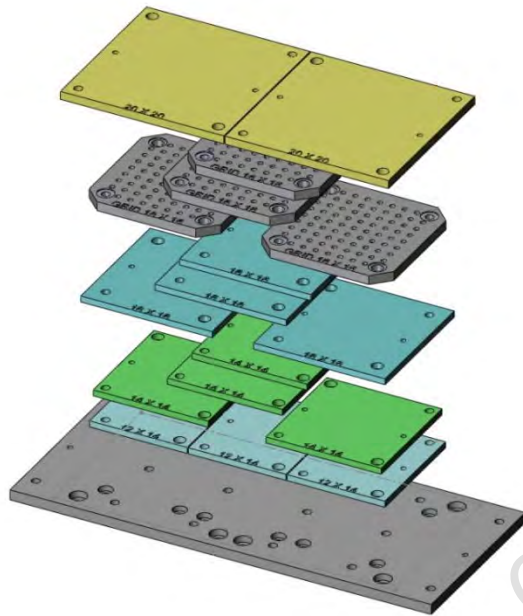
☐ VCN510C-004



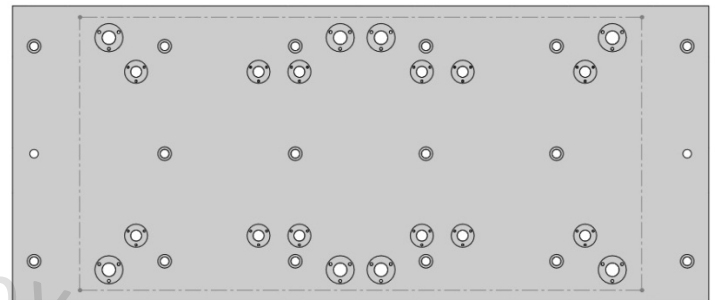
☐ 28745 Aluminum ☐ 28845 Steel



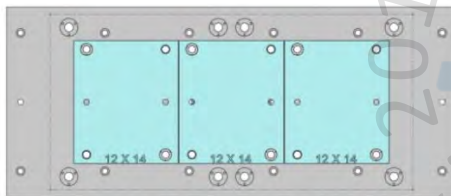
VCN510C-005



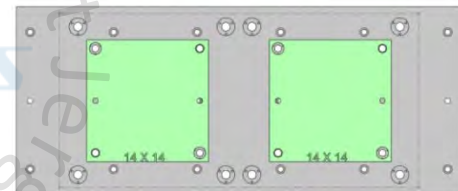
51.1 X 21.6 X 1.25



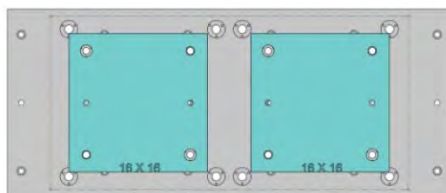
☐ VCN510C-005



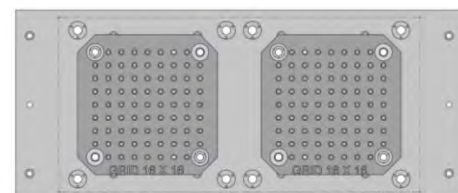
☐ 28711 Aluminum ☐ 28811 Steel



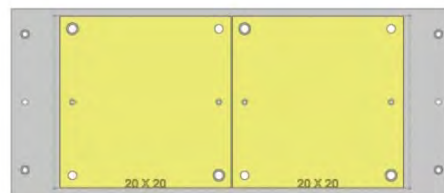
☐ 28713 Aluminum ☐ 28813 Steel



☐ 28715 Aluminum ☐ 28815 Steel



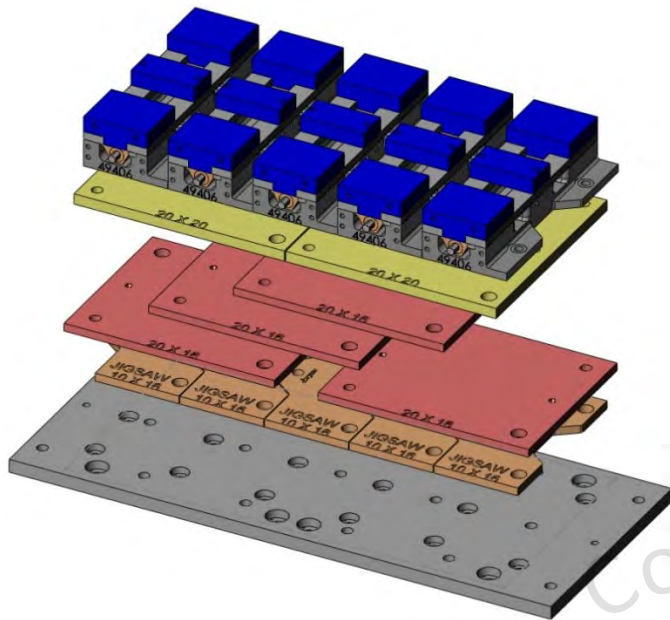
☐ 28801 Steel



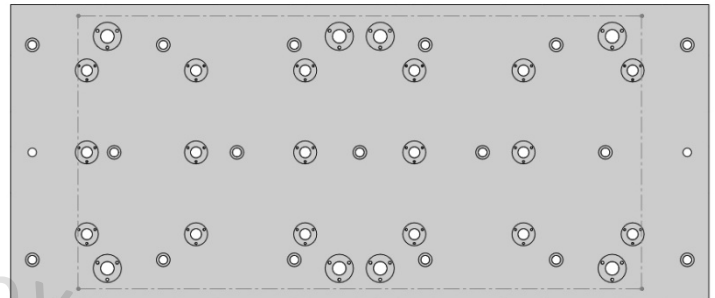
☐ 28727 Aluminum ☐ 28827 Steel



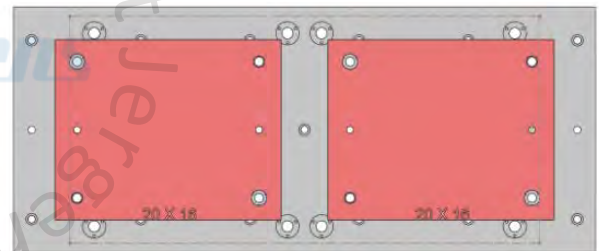
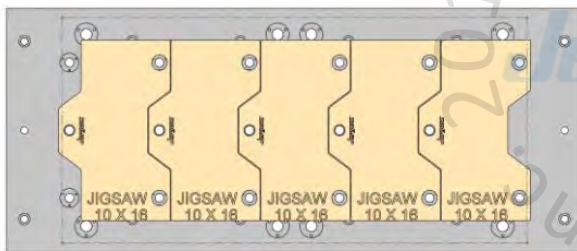
VCN510C-006



51.1 X 21.6 X 1.25



☐ VCN510C-006

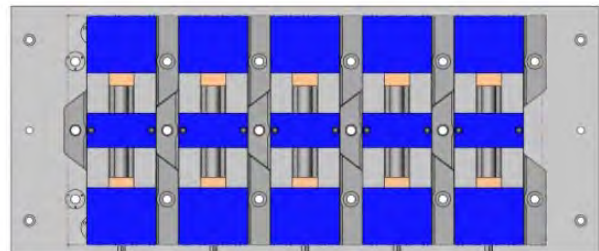
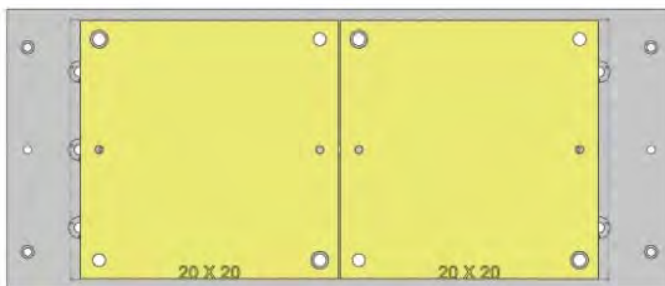


☐ 28706 Aluminum

☐ 28806 Steel

☐ 28719 Aluminum

☐ 28819 Steel

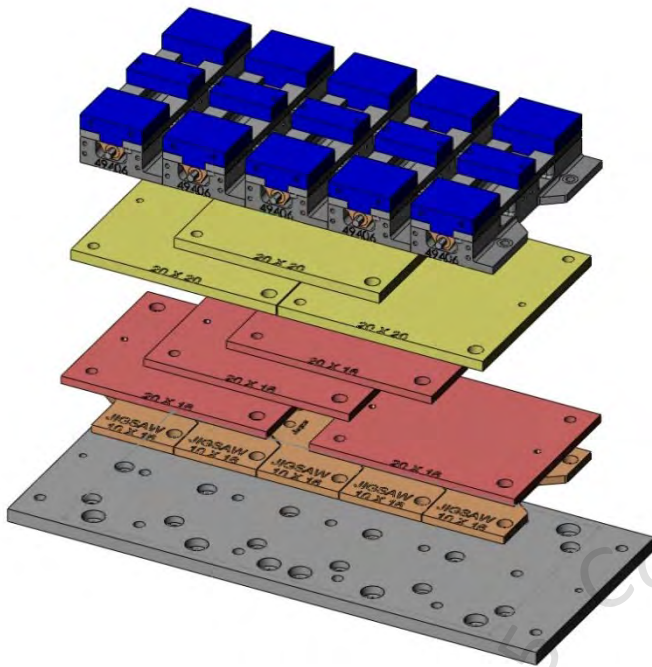


☐ 28727 Aluminum

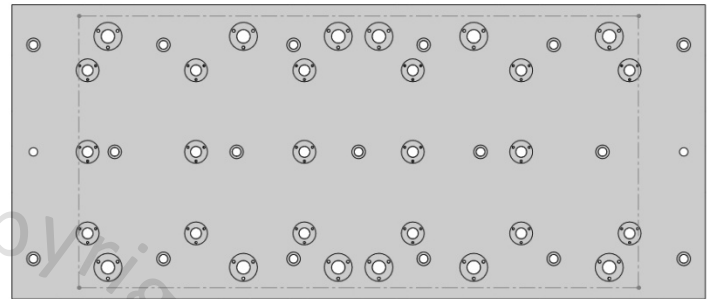
☐ 28827 Steel

☐ 49406 6" Vise Ball Lock® Base

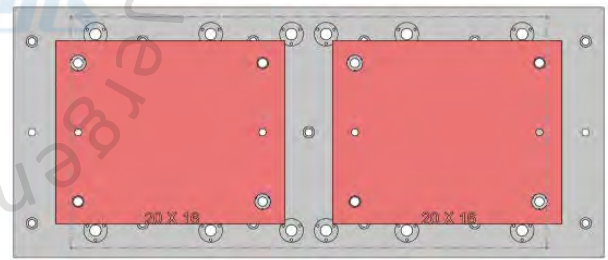
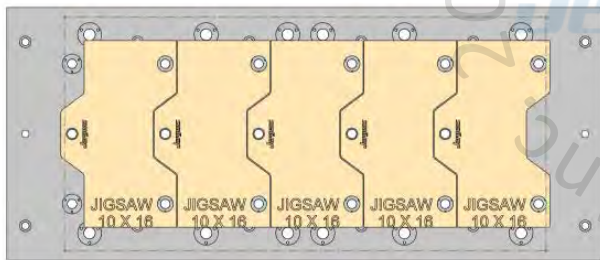
VCN510C-007



51.1 X 21.6 X 1.25

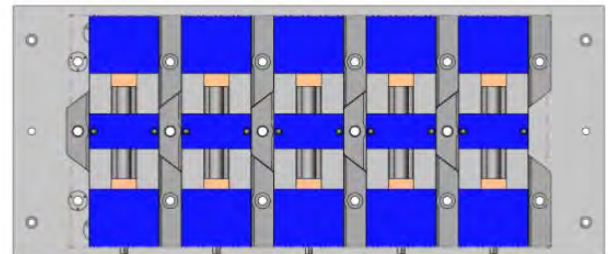
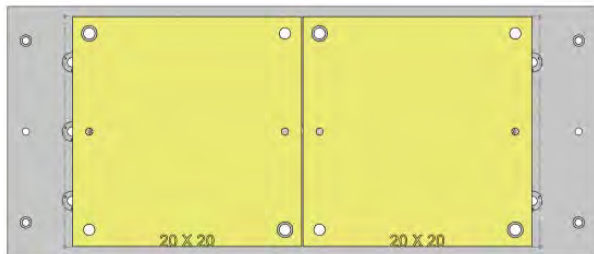


☐ VCN510C-007



☐ 28706 Aluminum ☐ 28806 Steel

☐ 28719 Aluminum ☐ 28819 Steel

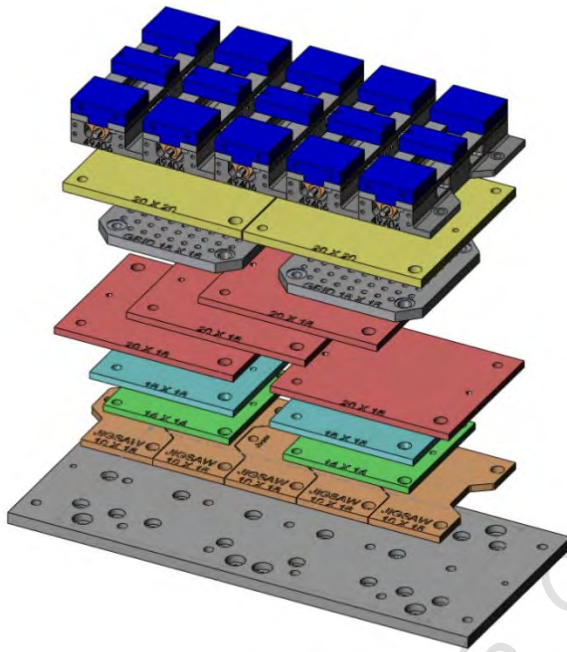


☐ 28727 Aluminum ☐ 28827 Steel

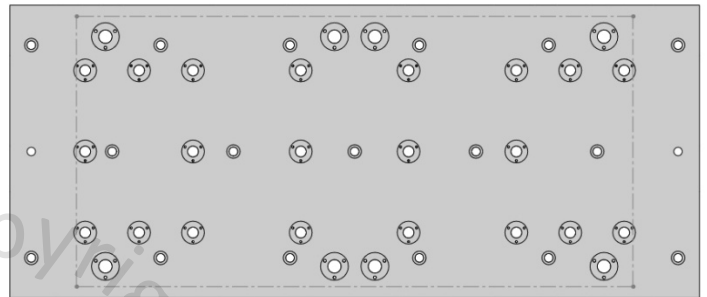
☐ 49406 6" Vise Ball Lock® Base



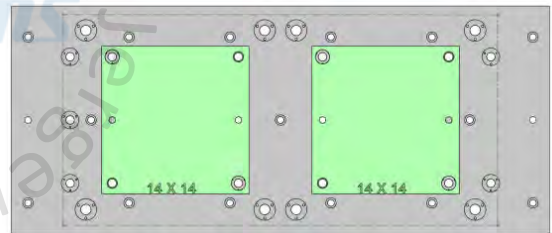
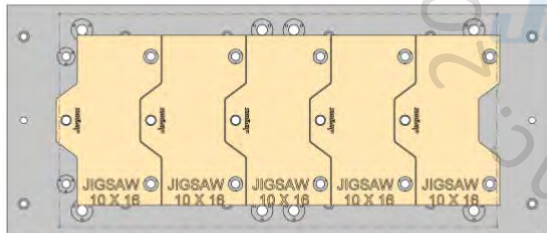
VCN510C-008



51.1 X 21.6 X 1.25

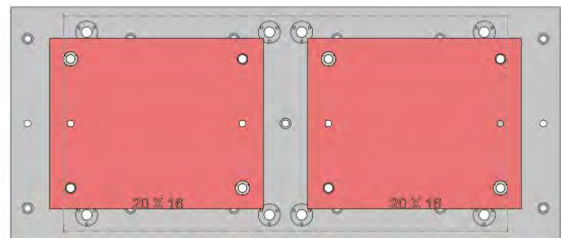
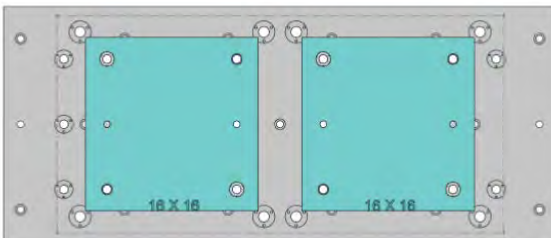


☐ VCN510C-008



☐ 28706 Aluminum ☐ 28806 Steel

☐ 28713 Aluminum ☐ 28813 Steel

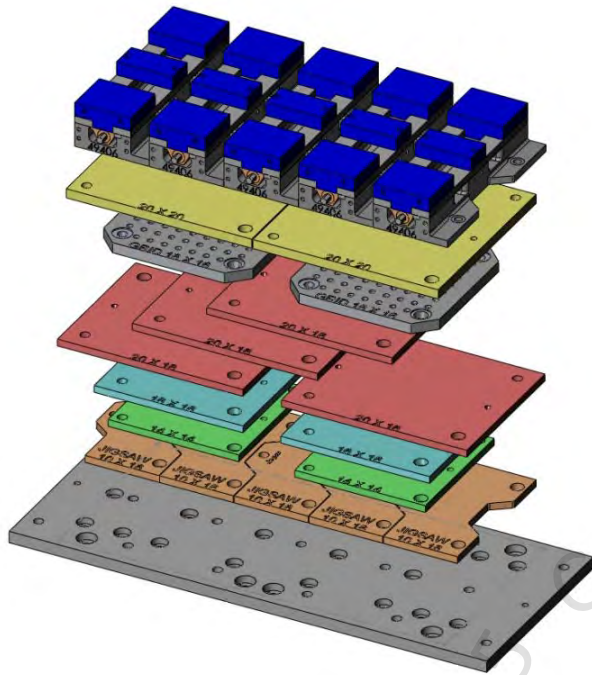


☐ 28715 Aluminum ☐ 28815 Steel

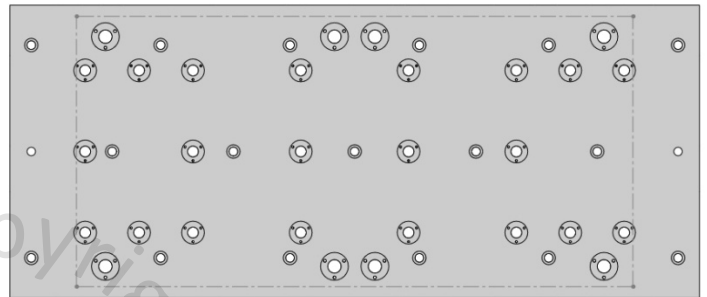
☐ 28719 Aluminum ☐ 28819 Steel



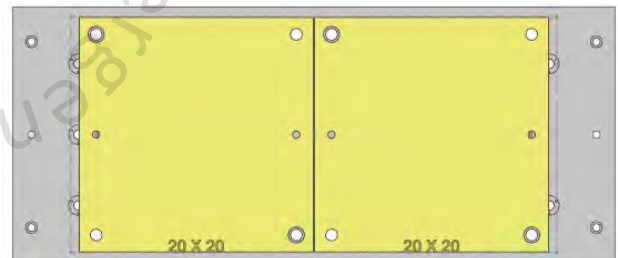
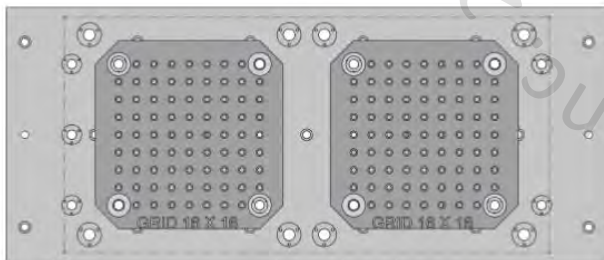
VCN510C-008 (CONTINUED)



51.1 X 21.6 X 1.25



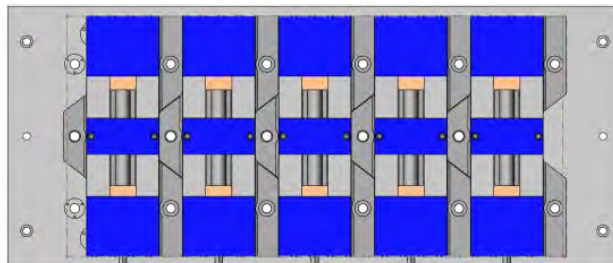
☐ VCN510C-008



☐ 28801 Steel

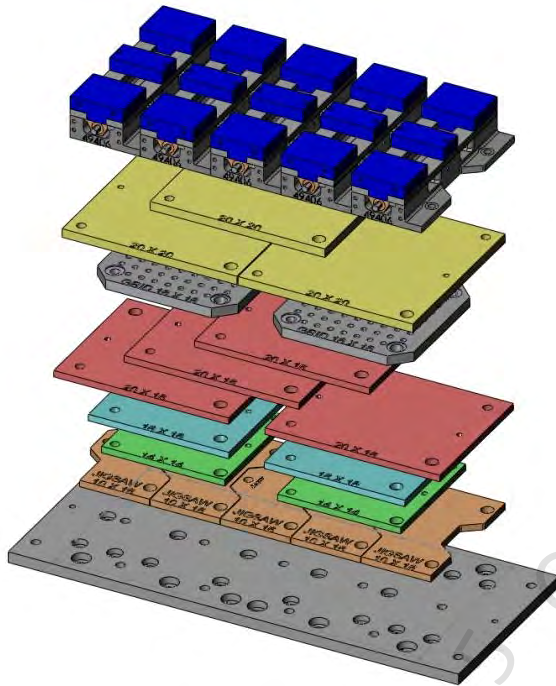
☐ 28727 Aluminum

☐ 28827 Steel

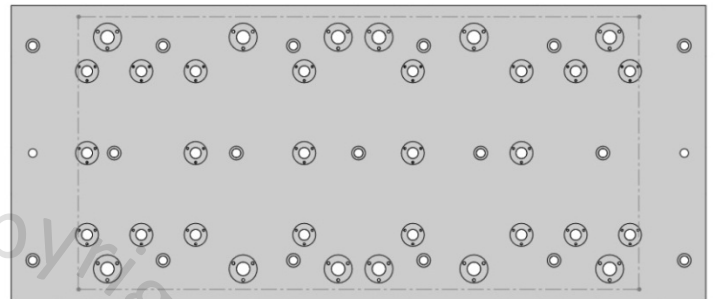


☐ 49406 6" Vise Ball Lock® Base

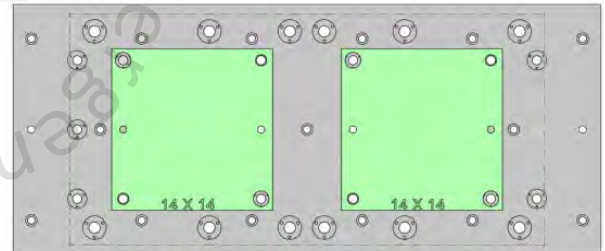
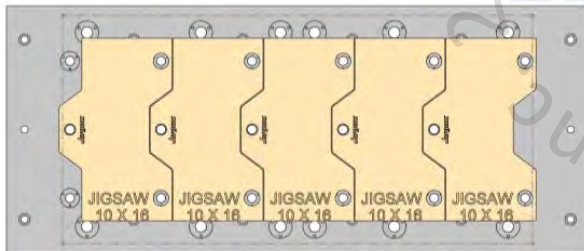
VCN510C-009



51.1 X 21.6 X 1.25

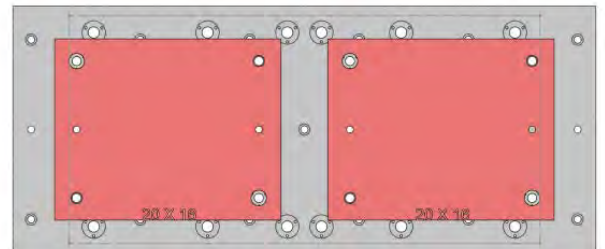
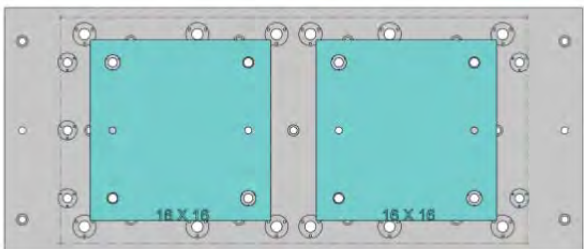


☐ VCN510C-009



☐ 28706 Aluminum ☐ 28806 Steel

☐ 28713 Aluminum ☐ 28813 Steel

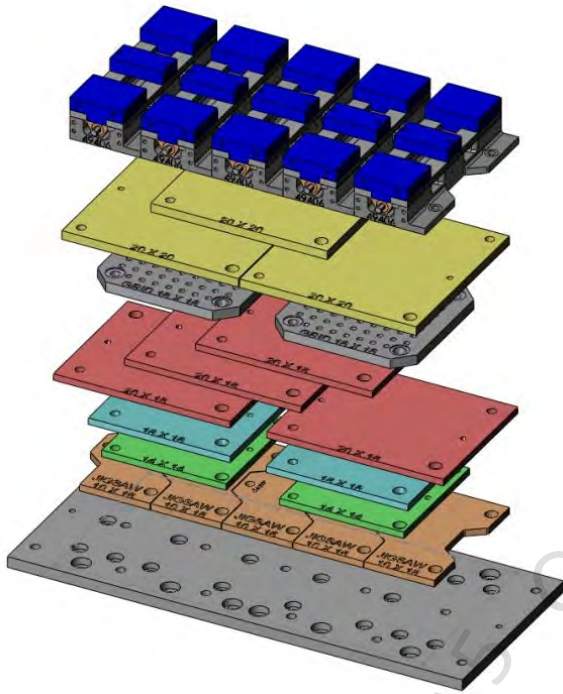


☐ 28715 Aluminum ☐ 28815 Steel

☐ 28719 Aluminum ☐ 28819 Steel

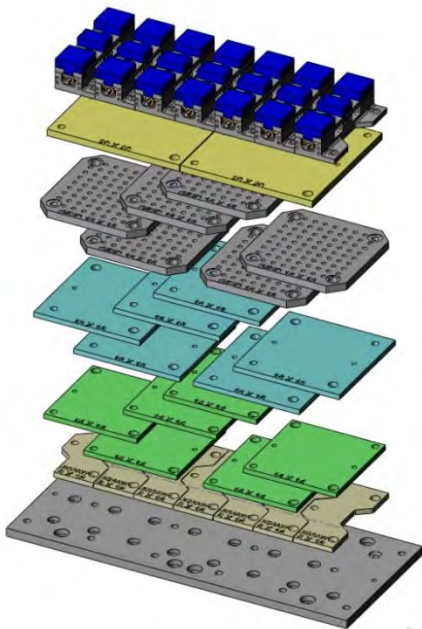


VCN510C-009 (CONTINUED)

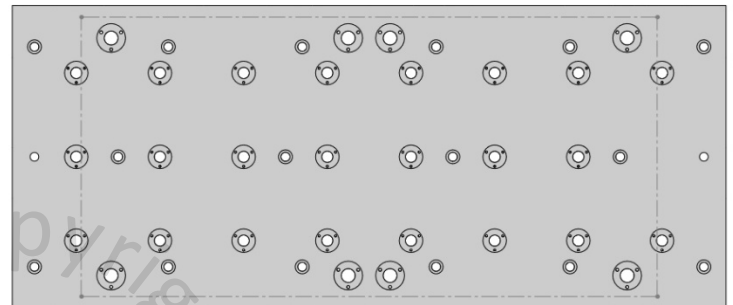




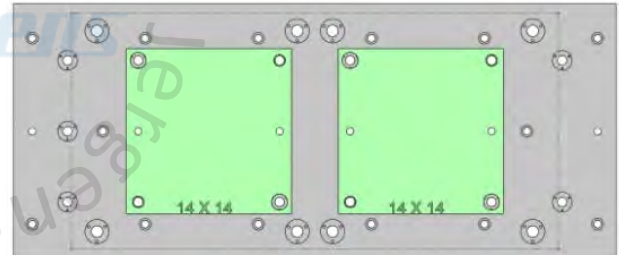
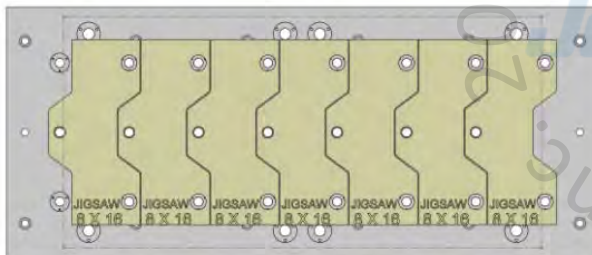
VCN510C-010



51.1 X 21.6 X 1.25

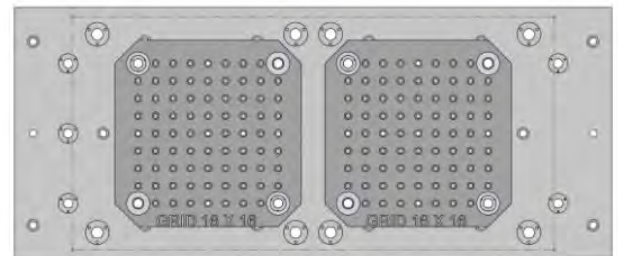
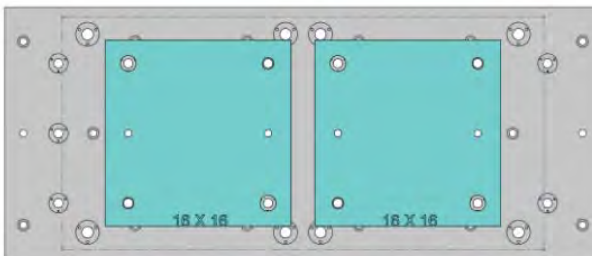


☐ VCN510C-010



☐ 28705 Aluminum ☐ 28805 Steel

☐ 28713 Aluminum ☐ 28813 Steel

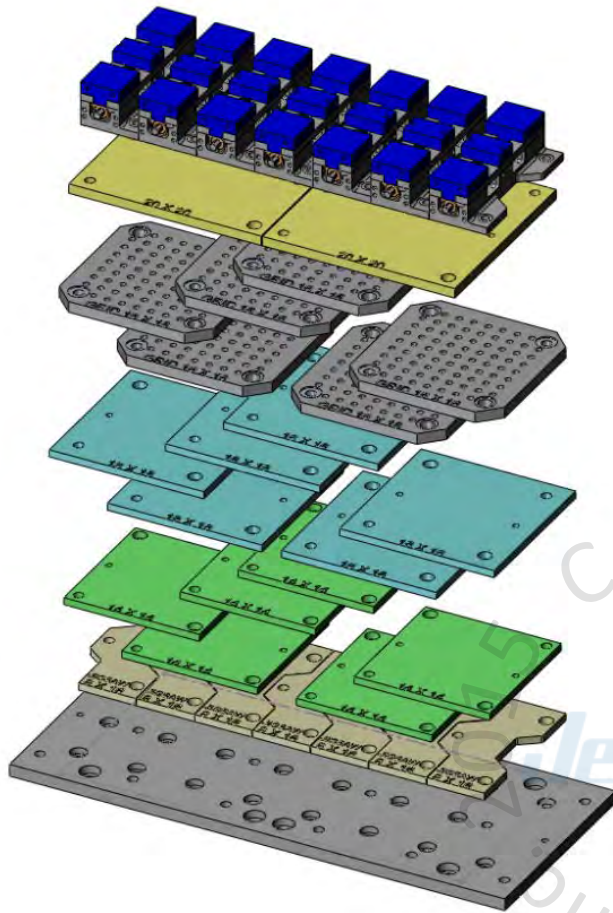


☐ 28715 Aluminum ☐ 28815 Steel

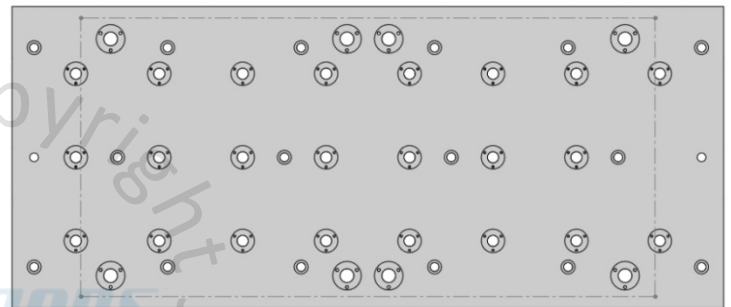
☐ 28801 Steel



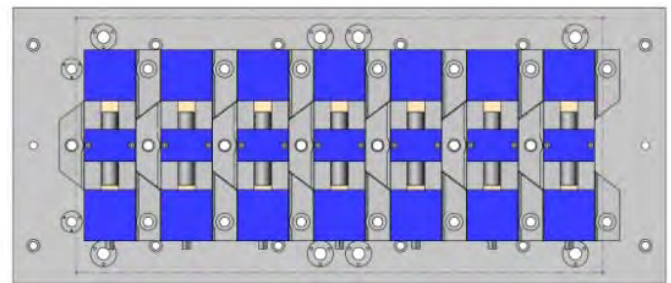
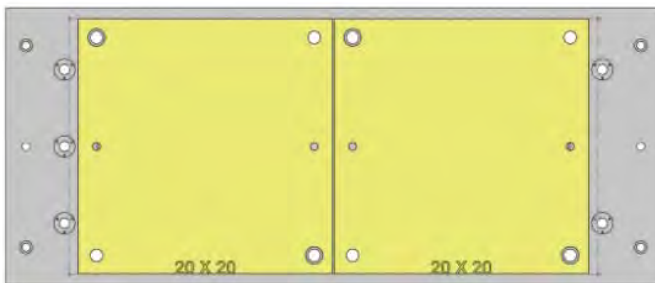
VCN510C-010 (CONTINUED)



51.1 X 21.6 X 1.25



☐ VCN510C-010



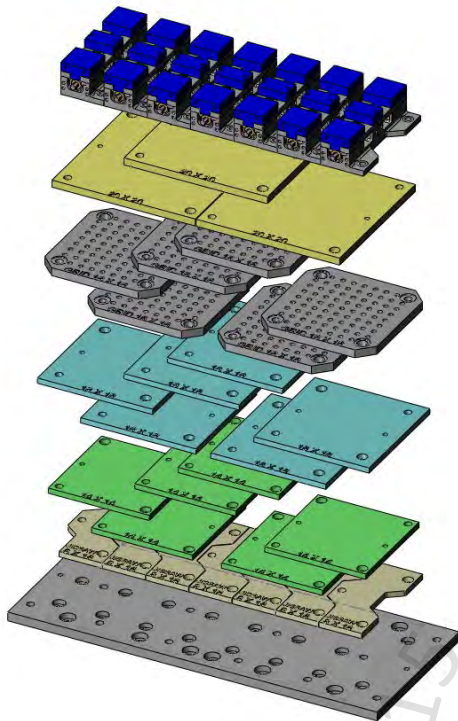
☐ 28727 Aluminum

☐ 28827 Steel

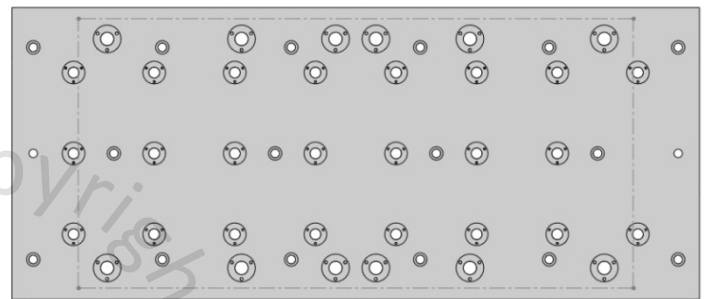
☐ 49405 4" Vise Ball Lock® Base



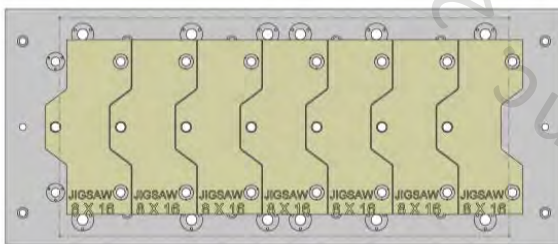
VCN510C-011



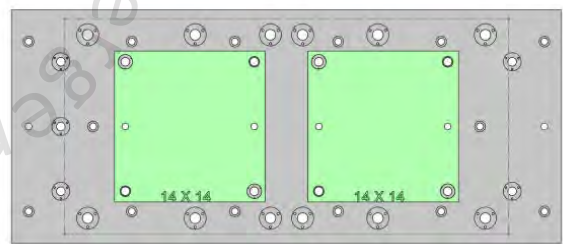
51.1 X 21.6 X 1.25



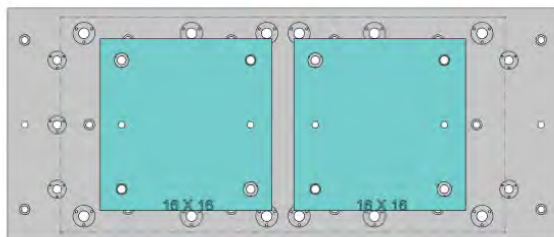
☐ VCN510C-011



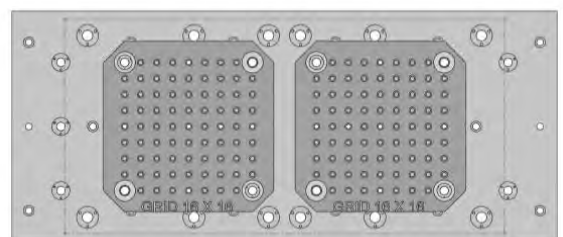
☐ 28705 Aluminum ☐ 28805 Steel



☐ 28713 Aluminum ☐ 28813 Steel



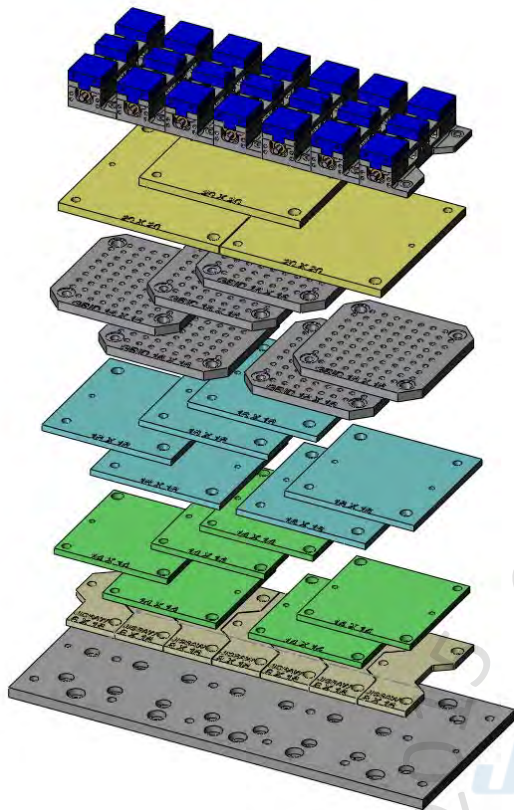
☐ 28715 Aluminum ☐ 28815 Steel



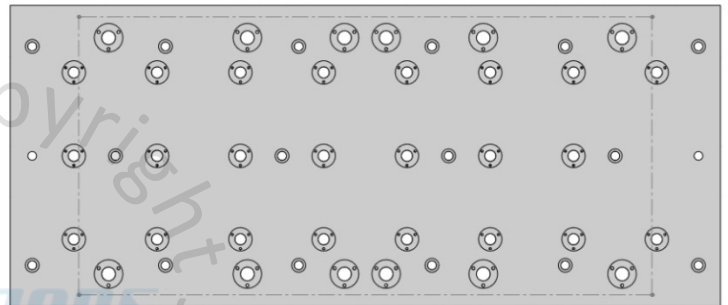
☐ 28801 Steel



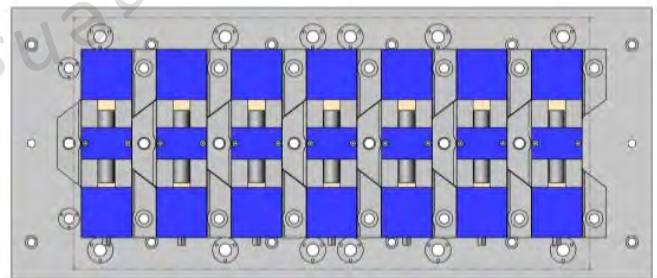
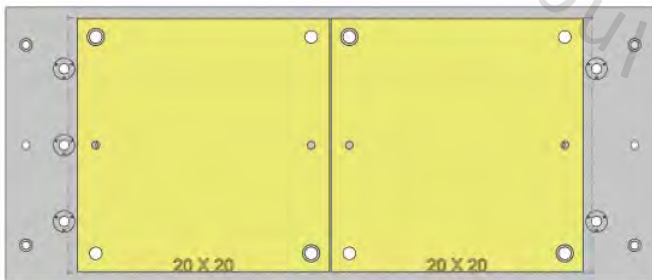
VCN510C-011 (Continued)



51.1 X 21.6 X 1.25



☐ VCN510C-010



☐ 28727 Aluminum

☐ 28827 Steel

☐ 49405 4" Vise Ball Lock® Base

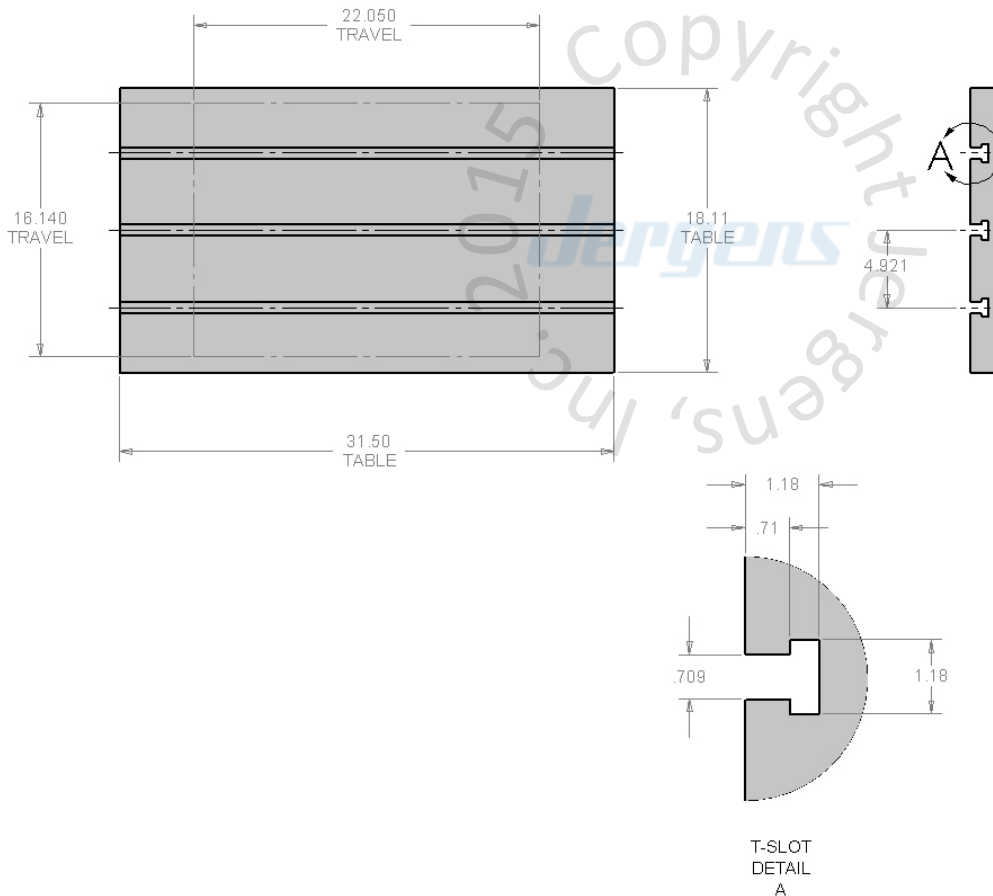


FJV-200



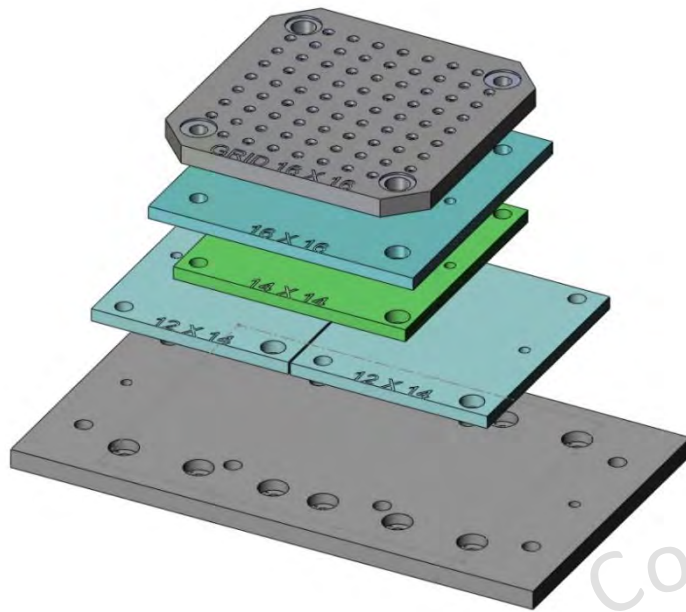
Table Specifications

- Table Travel (X, Y, Z): 22.05" x 16.14" x 16.14"
- Table Dimensions (L x W): 31.50" x 18.11"
- Maximum Weight on Table: 770 lbs
- T-Slot Width: .709" (18mm)
- T-Slot Center Distance: 4.921" (125mm)

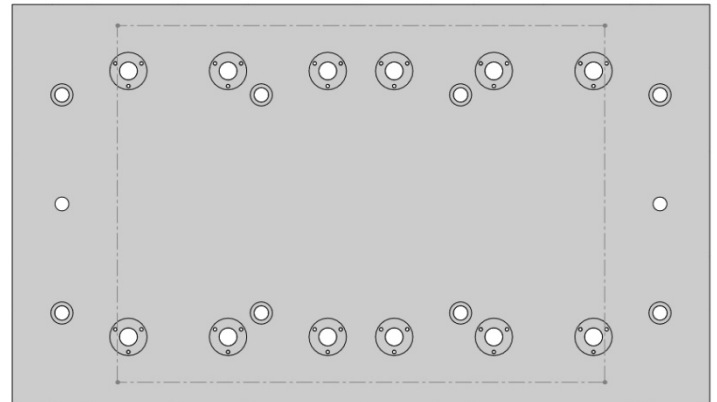




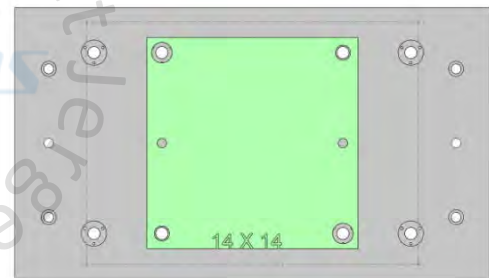
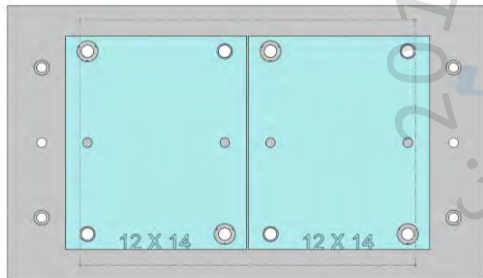
FJV200-001



31.5 X 18 X 1.125



☐ FJV200-001

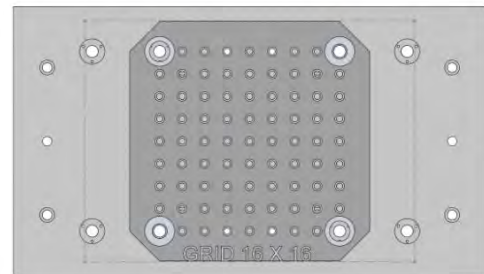
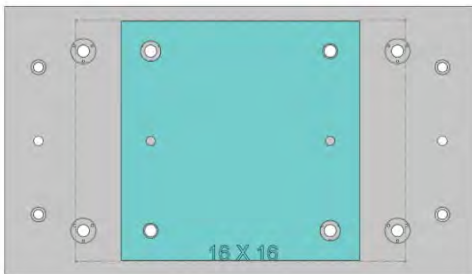


☐ 28711 Aluminum

☐ 28811 Steel

☐ 28713 Aluminum

☐ 28813 Steel



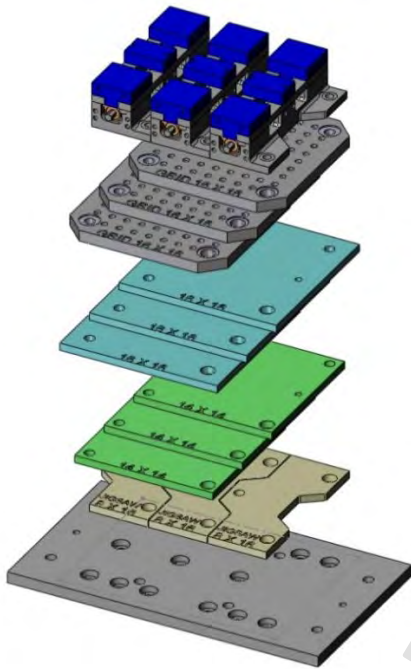
☐ 28715 Aluminum

☐ 28815 Steel

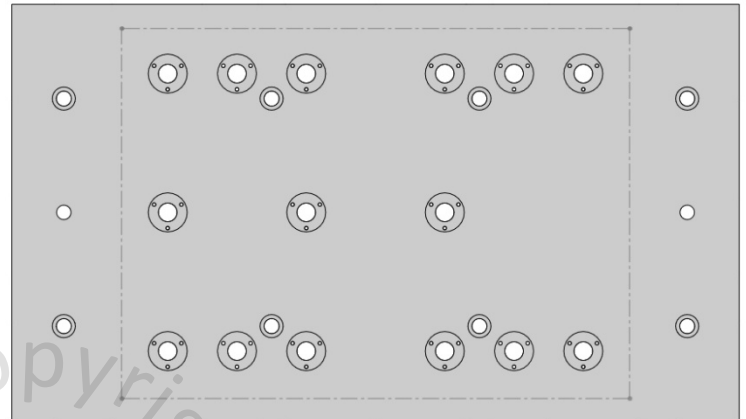
☐ 28801 Steel



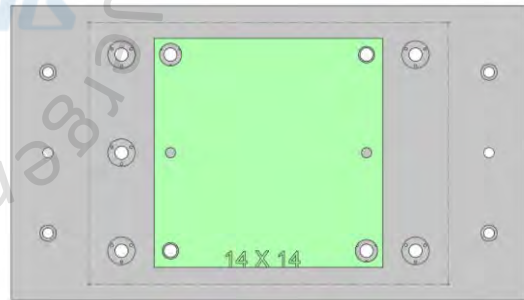
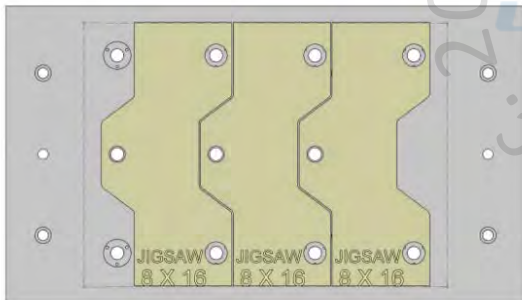
FJV200-002



31.5 X 18 X 1.125

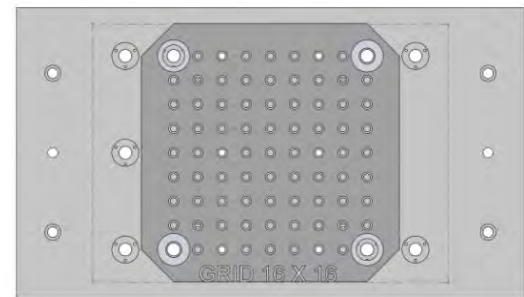
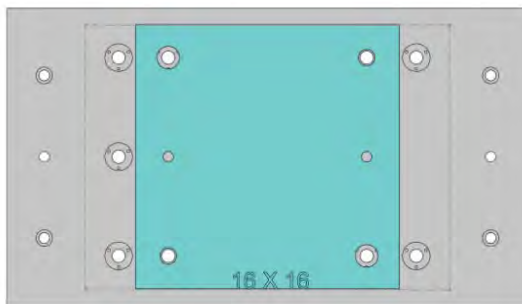


☐ FJV200-002



☐ 28705 Aluminum ☐ 28805 Steel

☐ 28713 Aluminum ☐ 28813 Steel

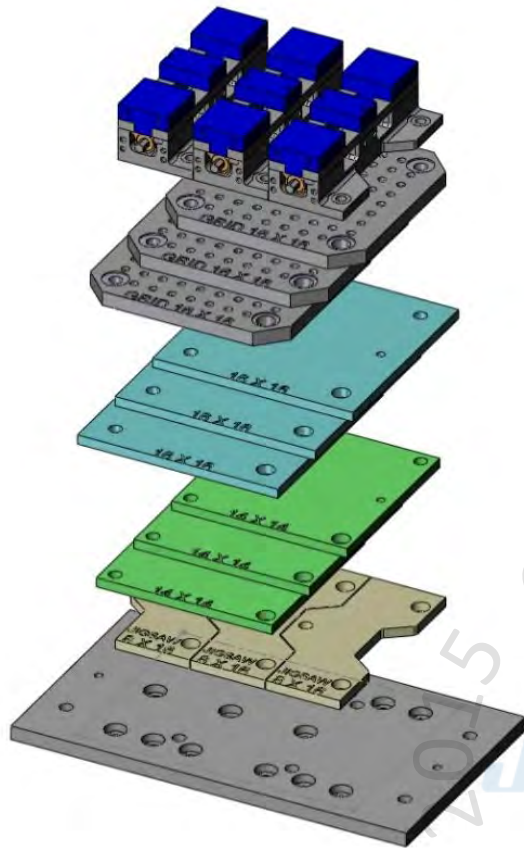


☐ 28715 Aluminum ☐ 28815 Steel

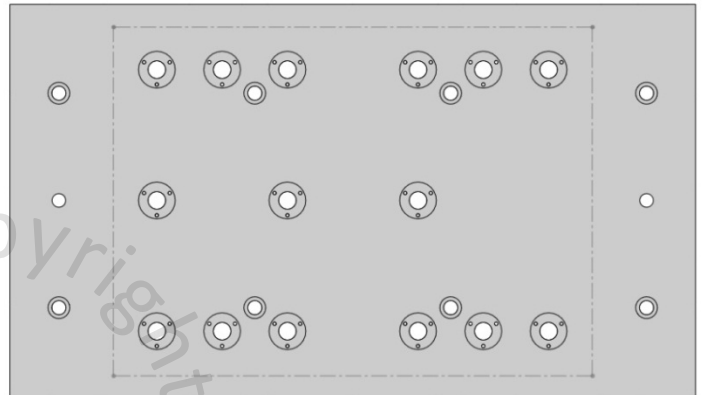
☐ 28801 Steel



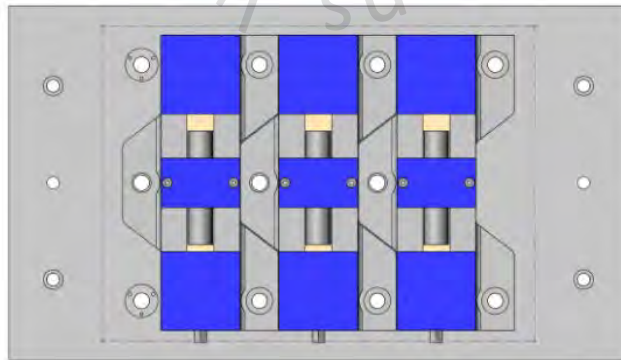
FJV200-002 (CONTINUED)



31.5 X 18 X 1.125



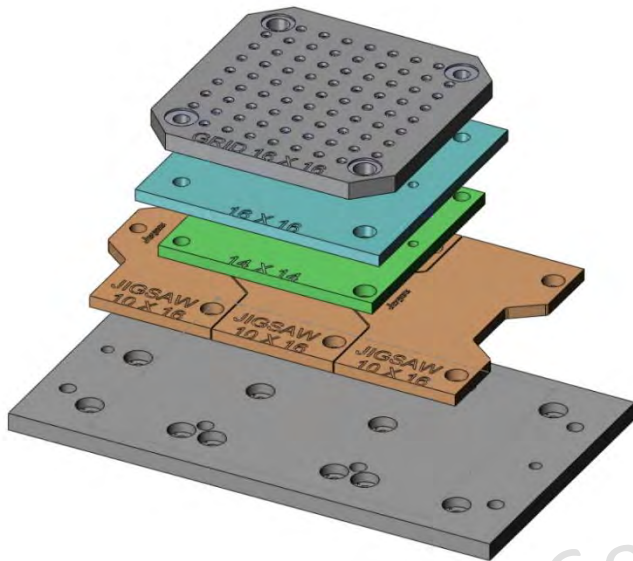
☐ FJV200-002



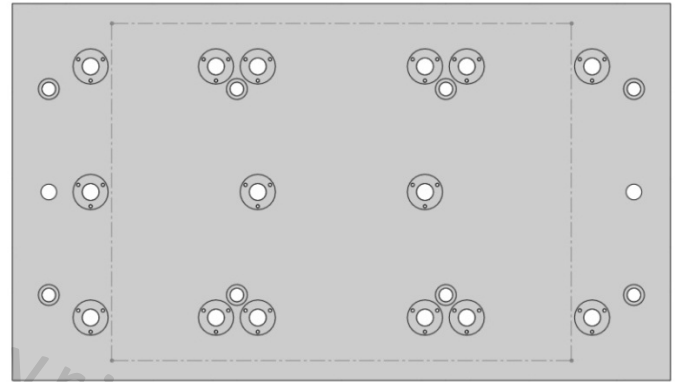
☐ 49405 4" Vise Ball Lock® Base



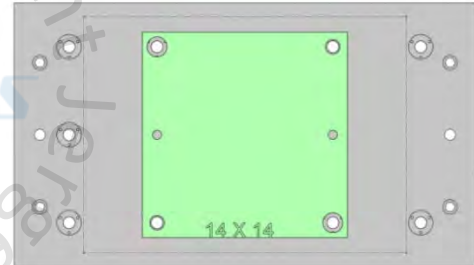
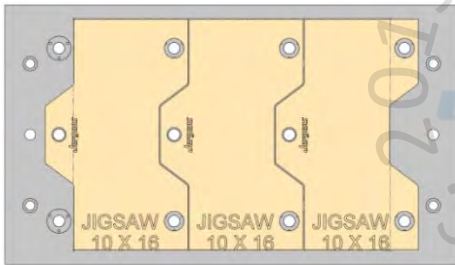
FJV200-003



31.5 X 18 X 1.125

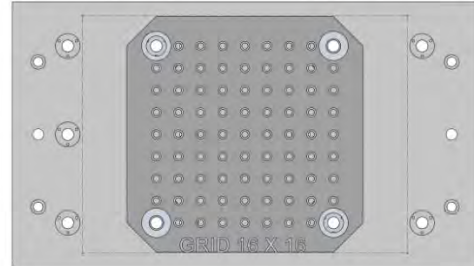
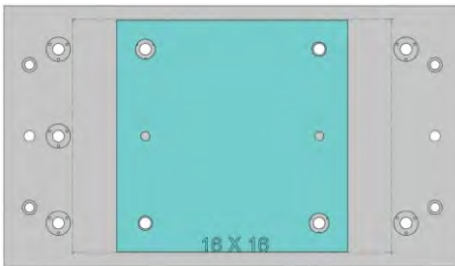


☐ FJV200-003



☐ 28706 Aluminum ☐ 28806 Steel

☐ 28713 Aluminum ☐ 28813 Steel

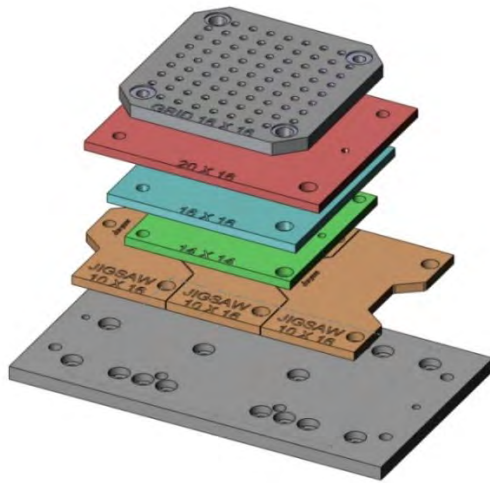


☐ 28715 Aluminum ☐ 28815 Steel

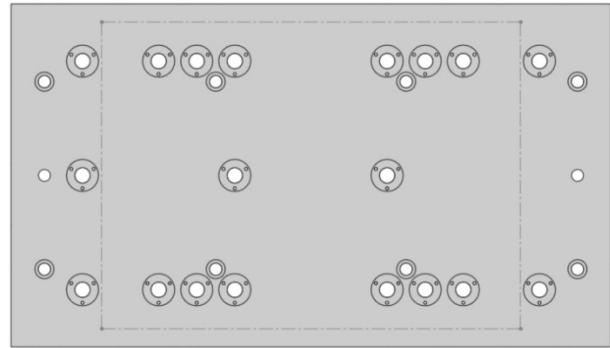
☐ 28801 Steel



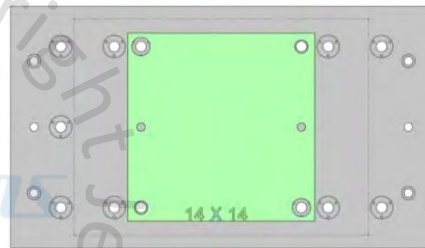
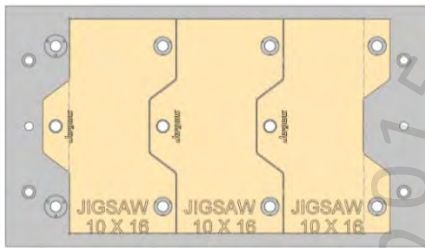
FJV200-004



31.5 X 18 X 1.125



☐ FJV200-004

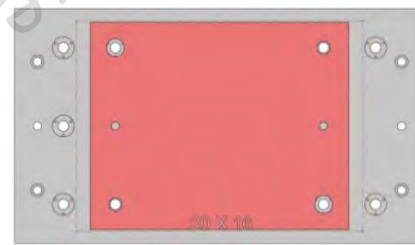
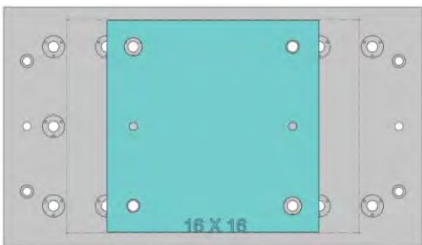


☐ 28706 Aluminum

☐ 28806 Steel

☐ 28713 Aluminum

☐ 28813 Steel

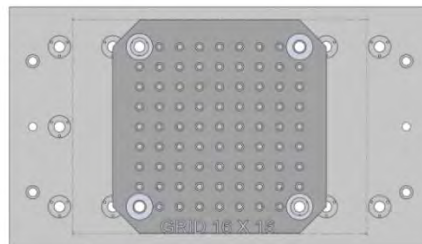


☐ 28715 Aluminum

☐ 28815 Steel

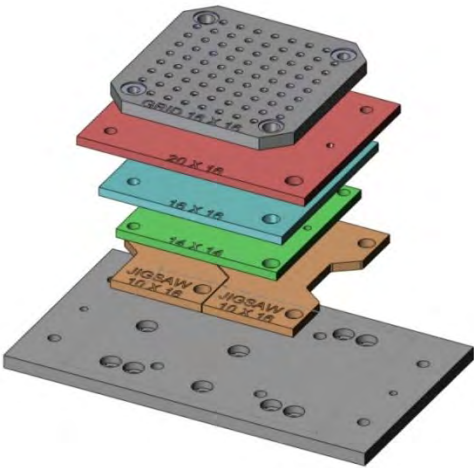
☐ 28719 Aluminum

☐ 28819 Steel

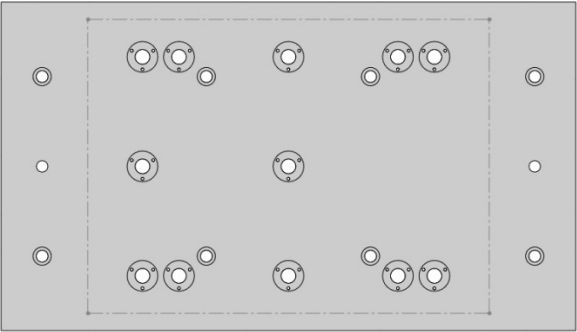


☐ 28801 Steel

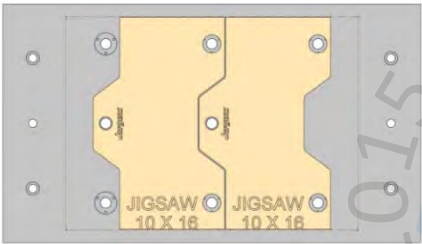
FJV200-005



31.5 X 18 X 1.125

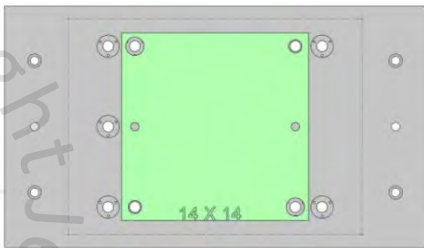


☐ FJV200-005



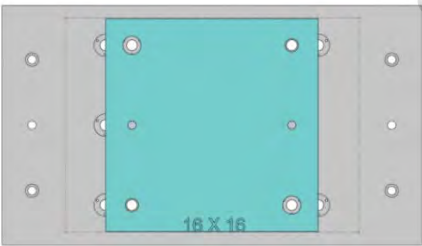
☐ 28706 Aluminum

☐ 28806 Steel



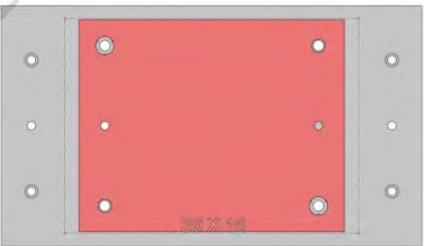
☐ 28713 Aluminum

☐ 28813 Steel



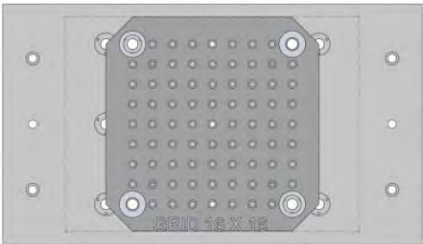
☐ 28715 Aluminum

☐ 28815 Steel



☐ 28719 Aluminum

☐ 28819 Steel



☐ 28801 Steel

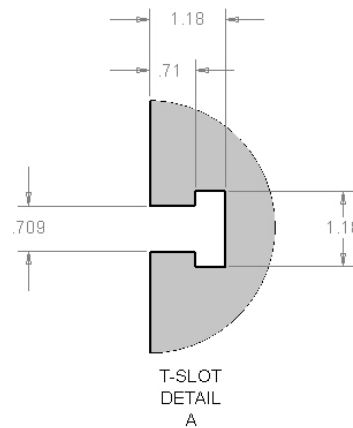
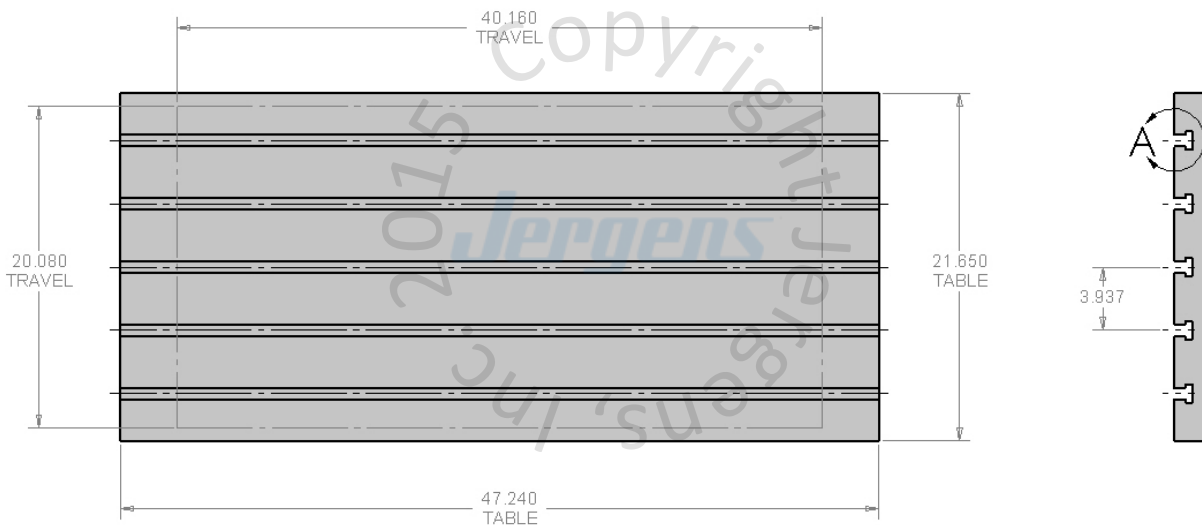


FJV-250

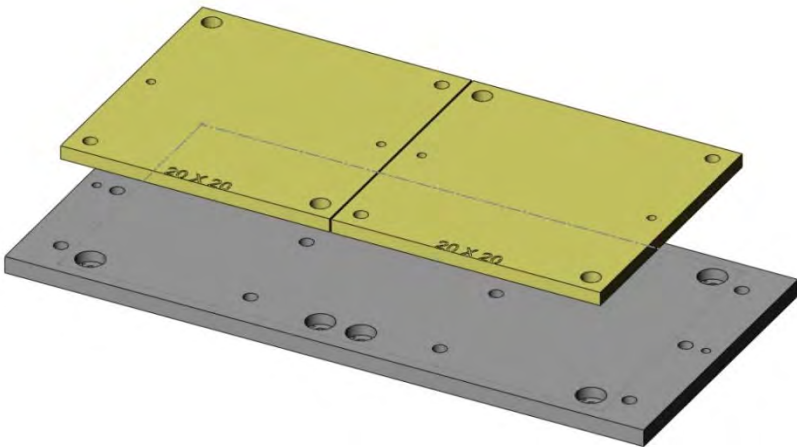


Table Specifications

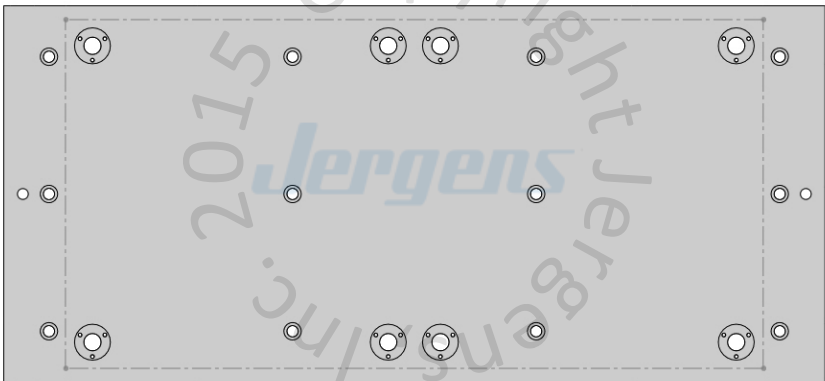
- Table Travel (X, Y, Z): 40.16" x 20.08" x 18.11"
- Table Dimensions (L x W): 47.24" x 21.65"
- Maximum Weight on Table: 2640 lbs
- T-Slot Width: .709" (18mm)
- T-Slot Center Distance: 3.937" (100mm)



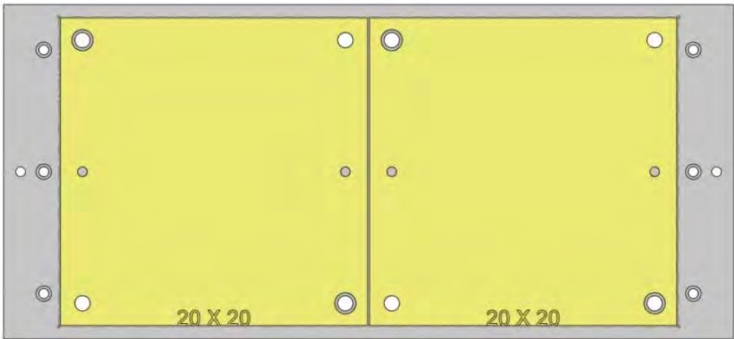
FJV250-001



47.2 X 21.6 X 1.25

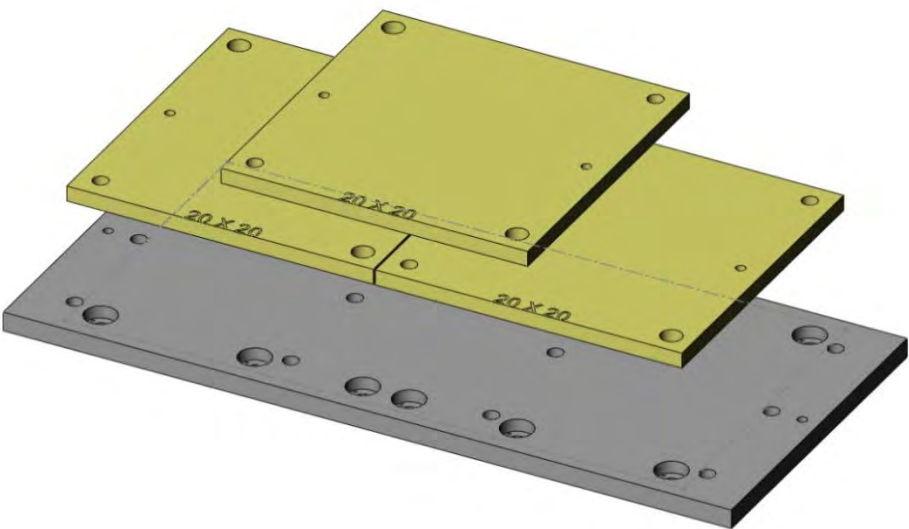


☐ FJV250-001

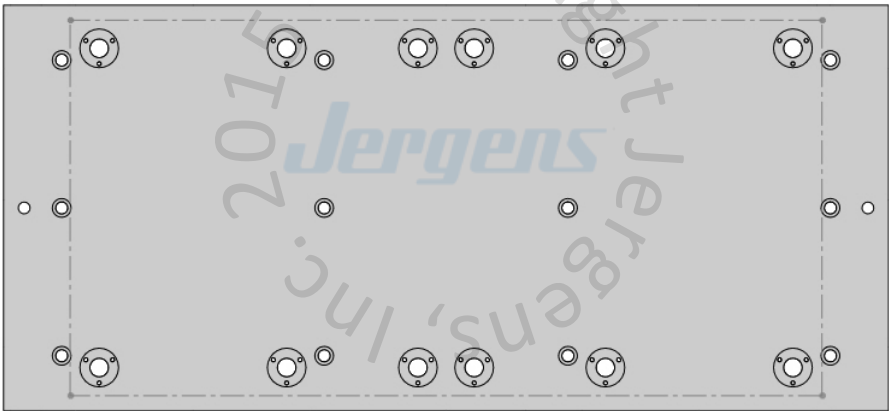


☐ 28727 Aluminum ☐ 28827 Steel

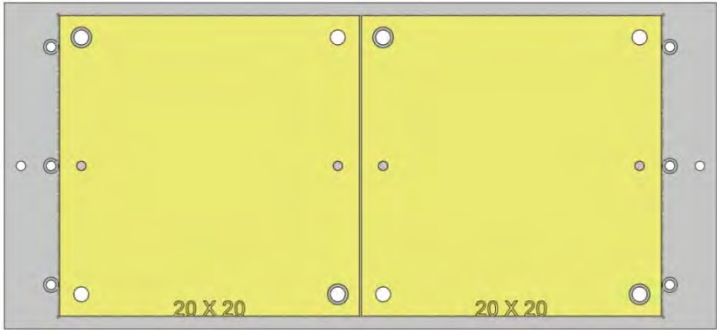
FJV250-002



47.2 X 21.6 X 1.25

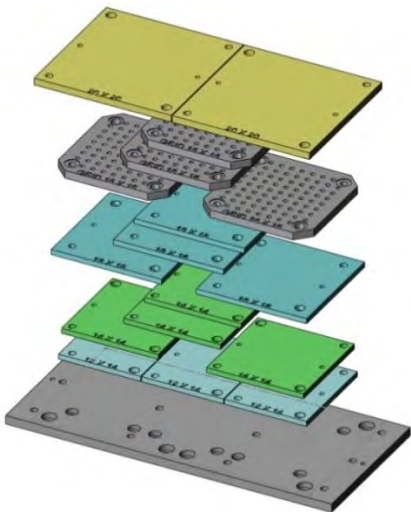


☐ FJV250-002

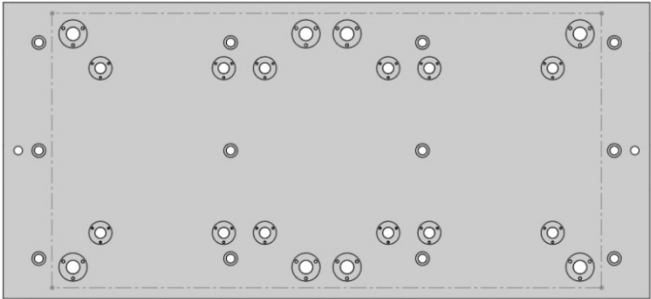


☐ 28727 Aluminum ☐ 28827 Steel

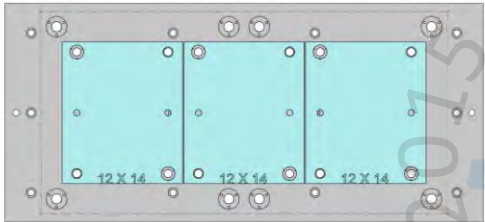
FJV250-003



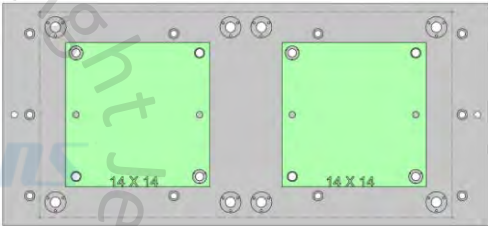
47.2 X 21.6 X 1.25



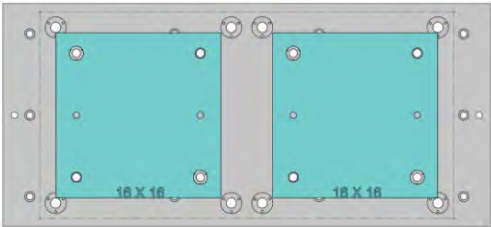
☐ FJV250-003



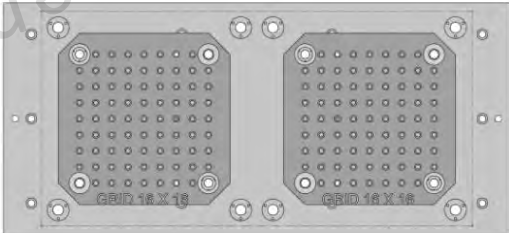
☐ 28711 Aluminum
 ☐ 28811 Steel



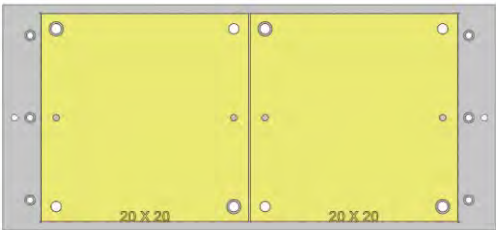
☐ 28713 Aluminum
 ☐ 28813 Steel



☐ 28715 Aluminum
 ☐ 28815 Steel



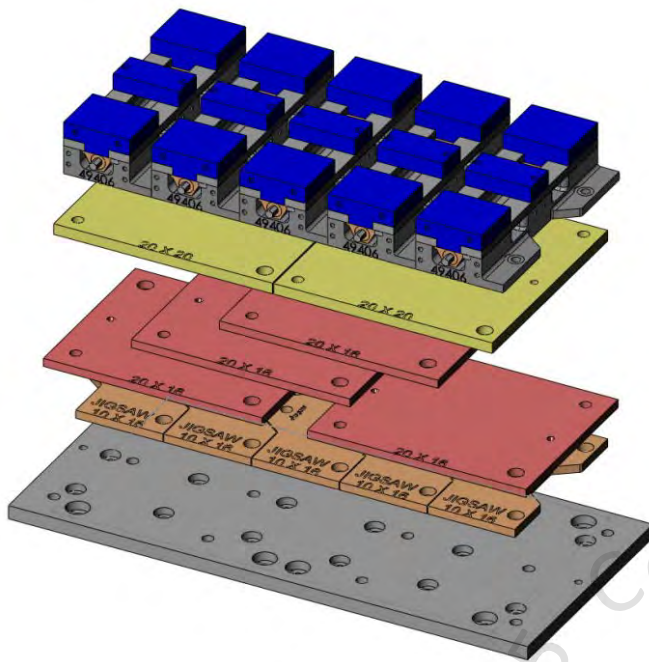
☐ 28801 Steel



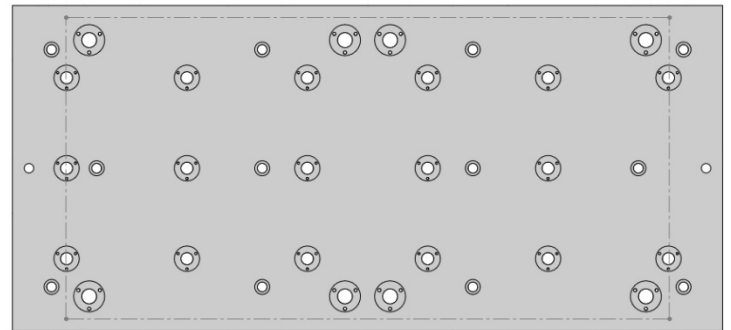
☐ 28727 Aluminum
 ☐ 28827 Steel



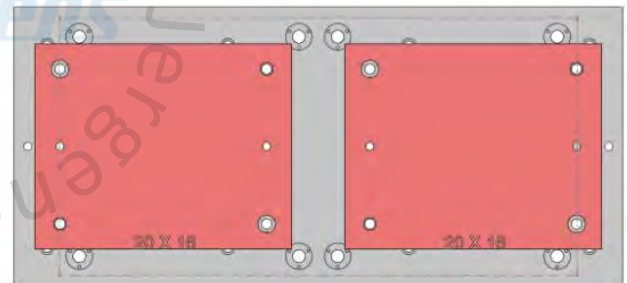
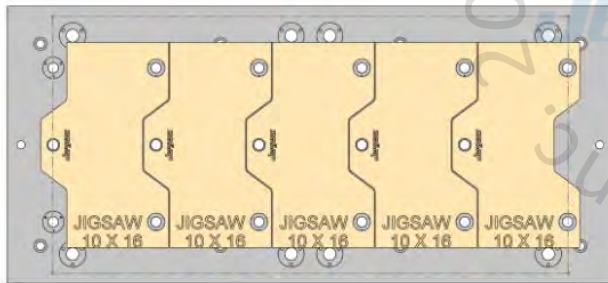
FJV250-004



47.2 X 21.6 X 1.25

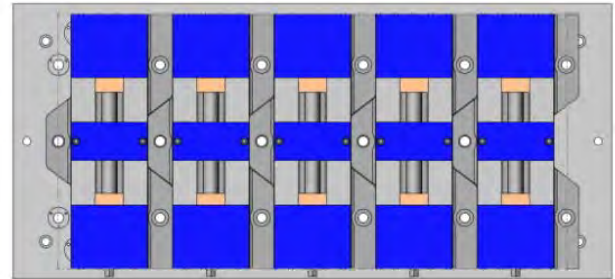
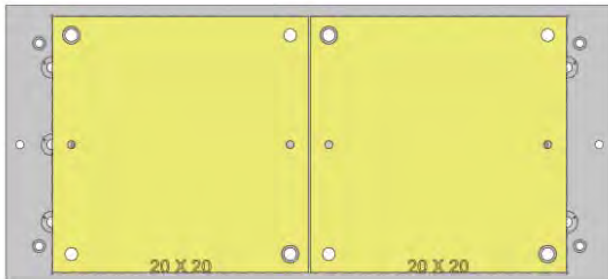


☐ FJV250-004



☐ 28706 Aluminum ☐ 28806 Steel

☐ 28719 Aluminum ☐ 28819 Steel

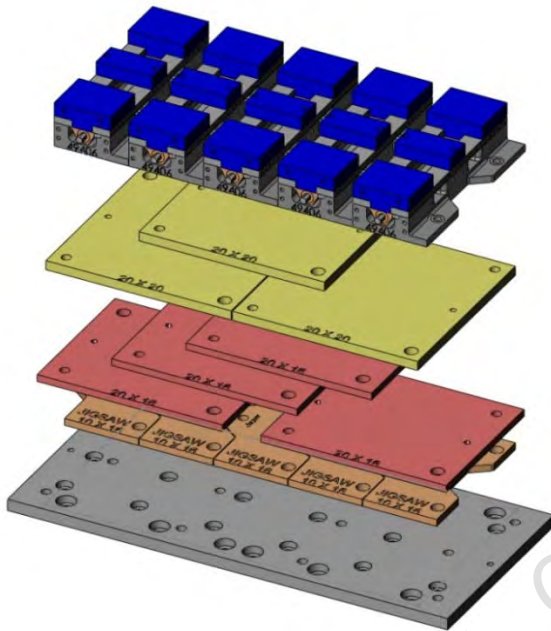


☐ 28727 Aluminum ☐ 28827 Steel

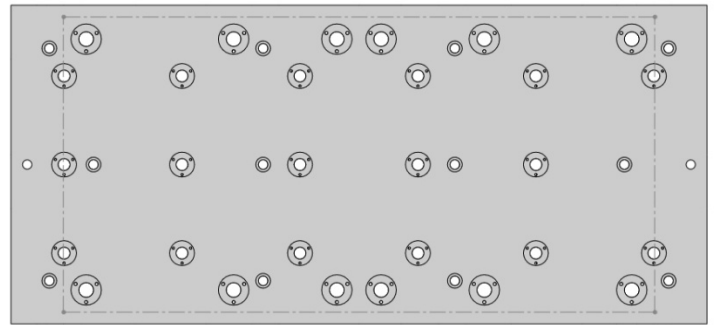
☐ 49406 6" Vise Ball Lock® Base



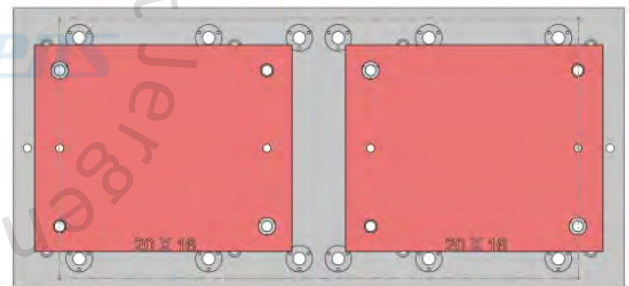
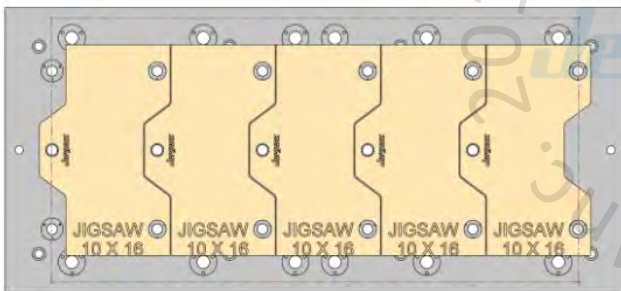
FJV250-005



47.2 X 21.6 X 1.25

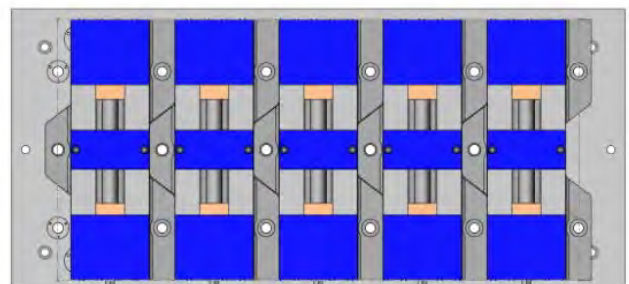
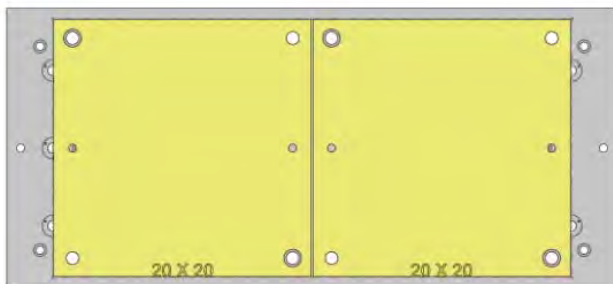


☐ FJV250-005



☐ 28706 Aluminum ☐ 28806 Steel

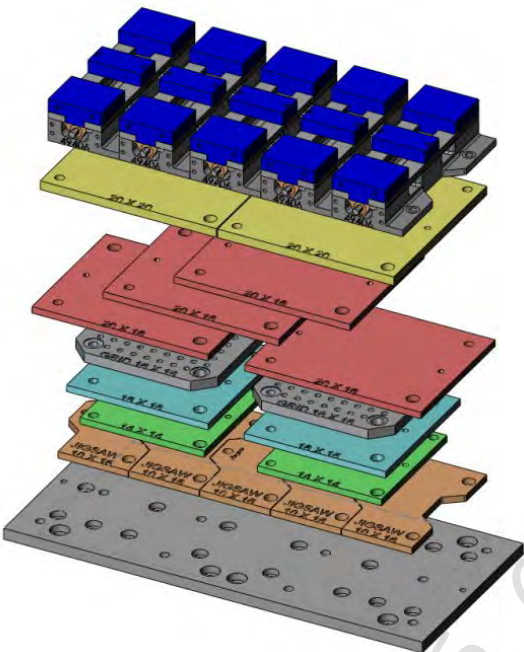
☐ 28719 Aluminum ☐ 28819 Steel



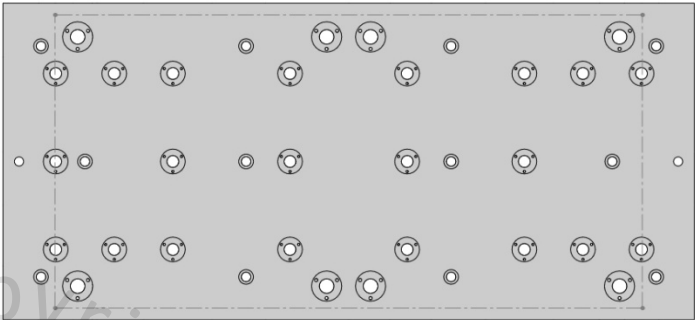
☐ 28727 Aluminum ☐ 28827 Steel

☐ 49406 6" Vise Ball Lock® Base

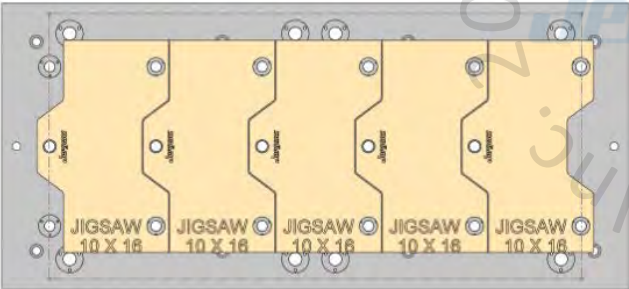
FJV250-006



47.2 X 21.6 X 1.25

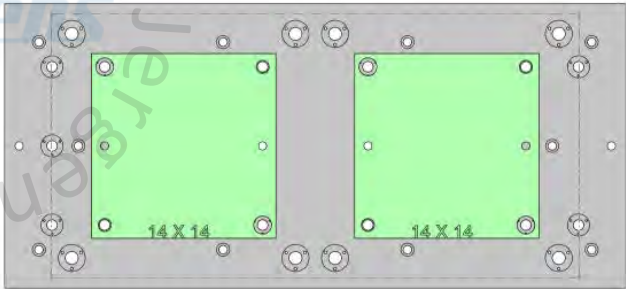


☐ FJV250-006



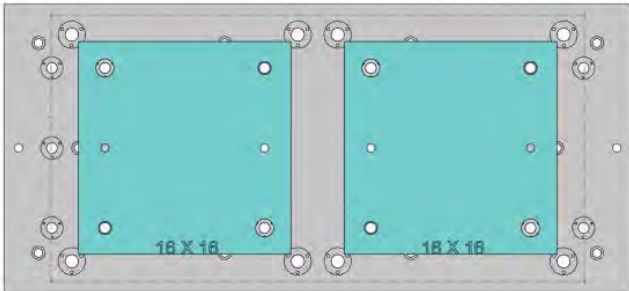
☐ 28706 Aluminum

☐ 28806 Steel



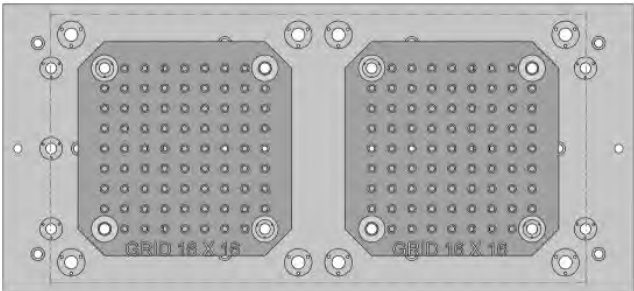
☐ 28713 Aluminum

☐ 28813 Steel



☐ 28715 Aluminum

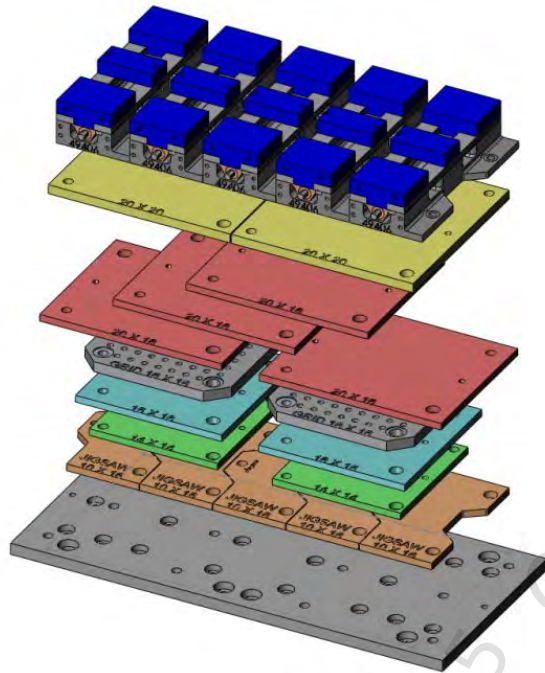
☐ 28815 Steel



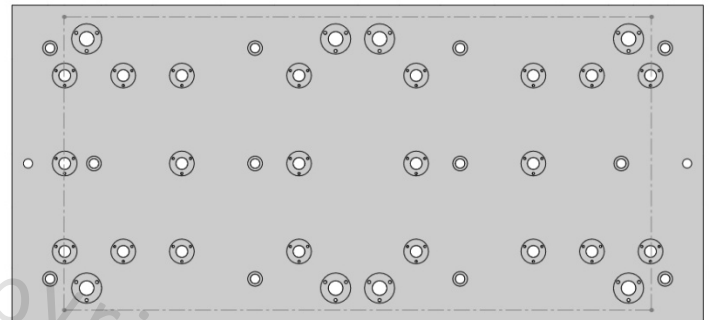
☐ 28801 Steel



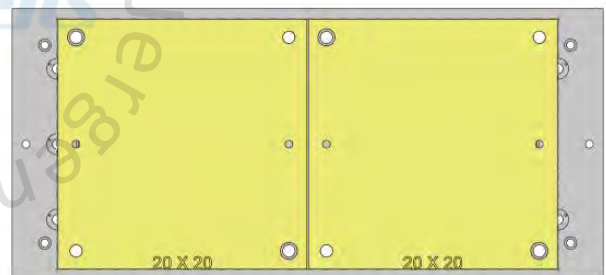
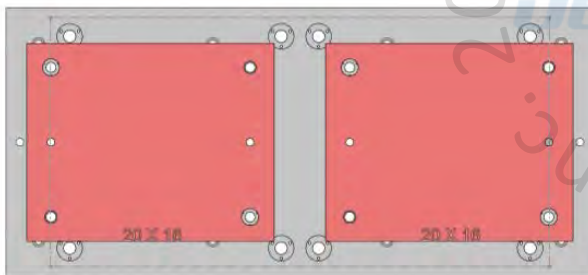
FJV250-006 (CONTINUED)



47.2 X 21.6 X 1.25



☐ FJV250-006

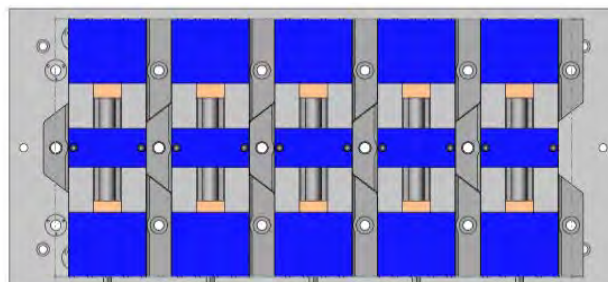


☐ 28719 Aluminum

☐ 28819 Steel

☐ 28727 Aluminum

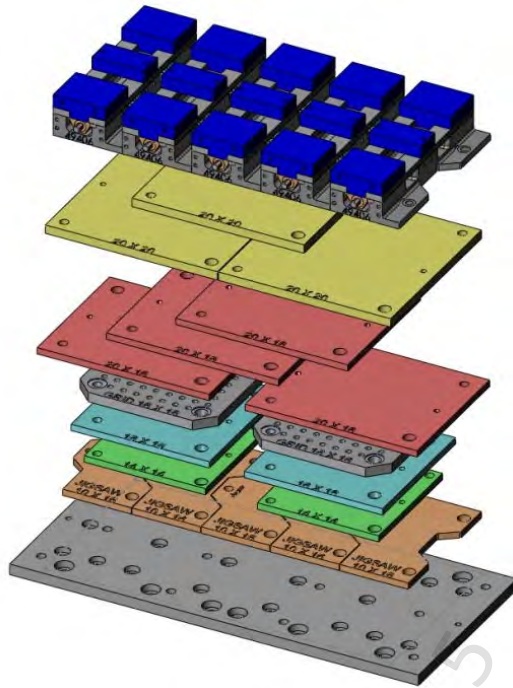
☐ 28827 Steel



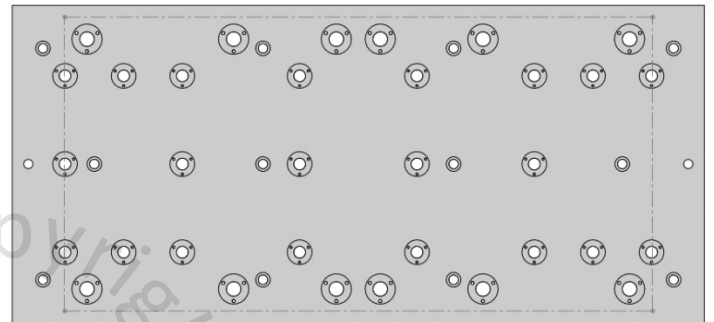
☐ 49406 6" Vise Ball Lock® Base



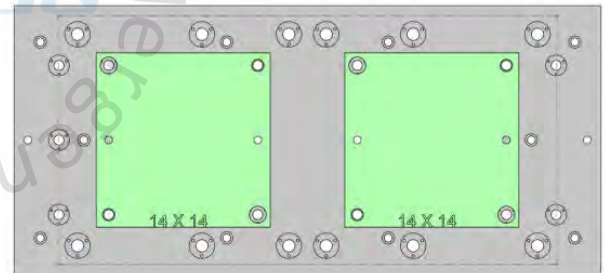
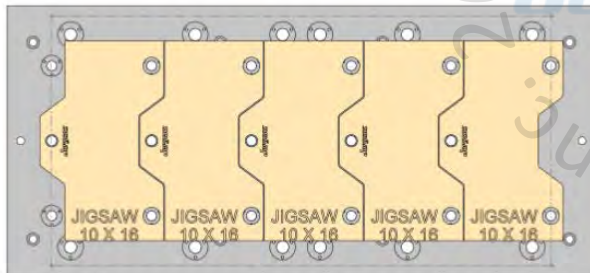
FJV250-007



47.2 X 21.6 X 1.25

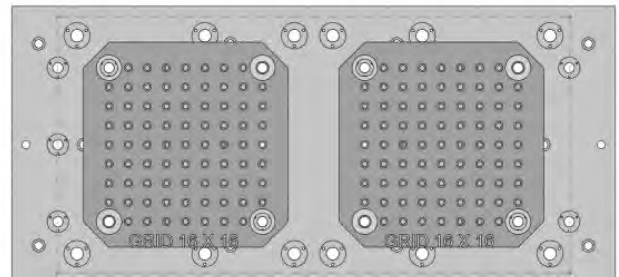
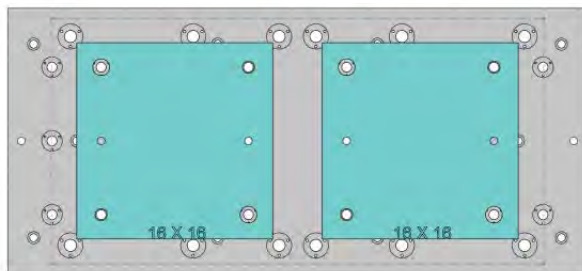


☐ FJV250-007



☐ 28706 Aluminum ☐ 28806 Steel

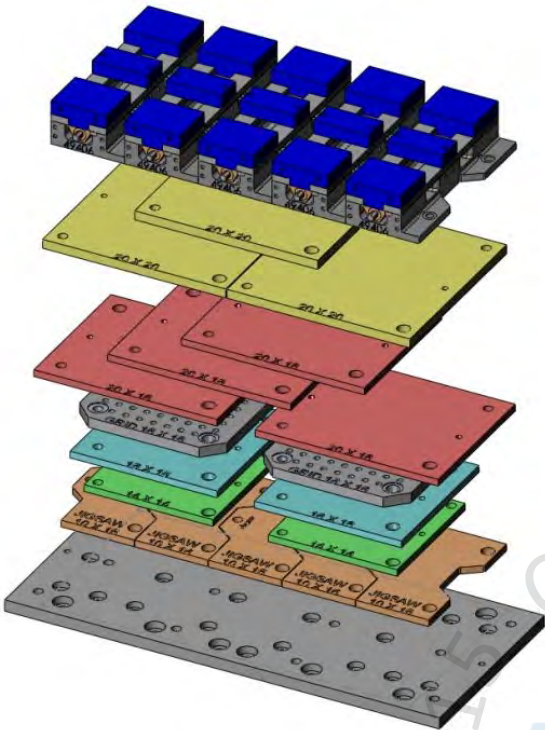
☐ 28713 Aluminum ☐ 28813 Steel



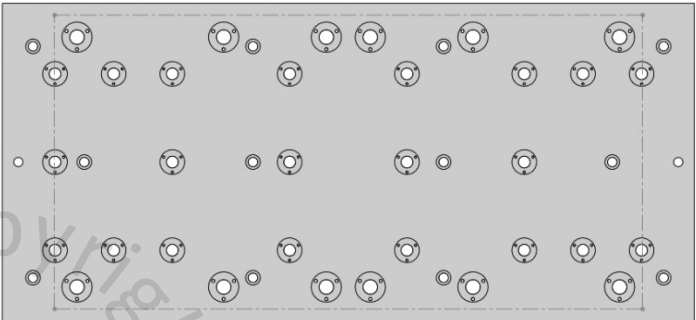
☐ 28715 Aluminum ☐ 28815 Steel

☐ 28801 Steel

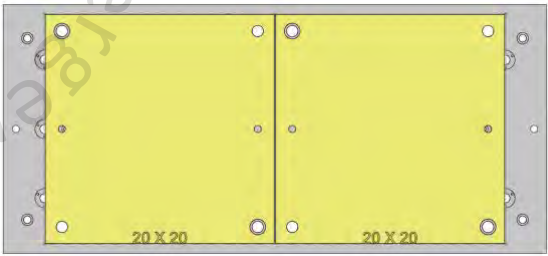
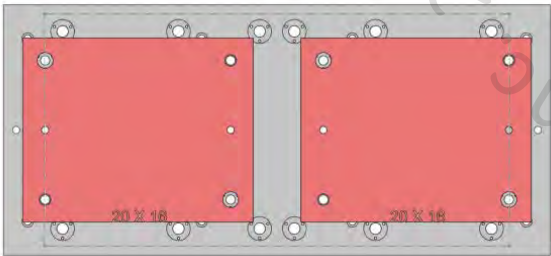
FJV250-007 (CONTINUED)



47.2 X 21.6 X 1.25



☐ FJV250-007

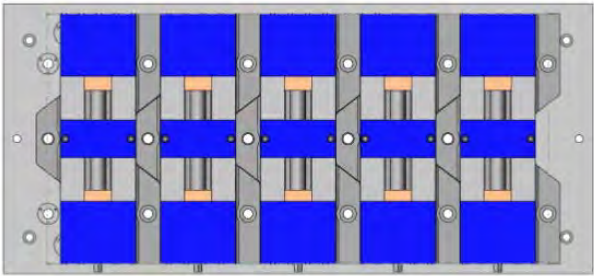


☐ 28719 Aluminum

☐ 28819 Steel

☐ 28727 Aluminum

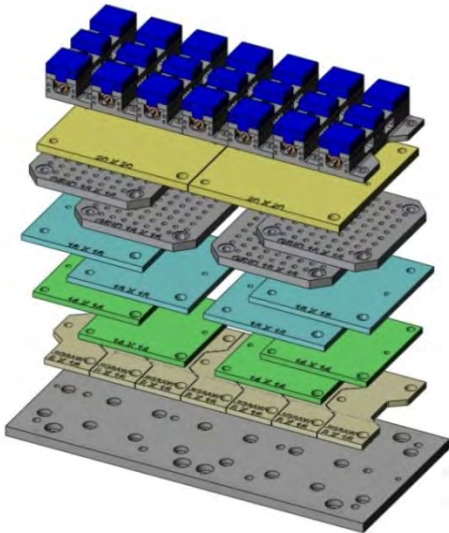
☐ 28827 Steel



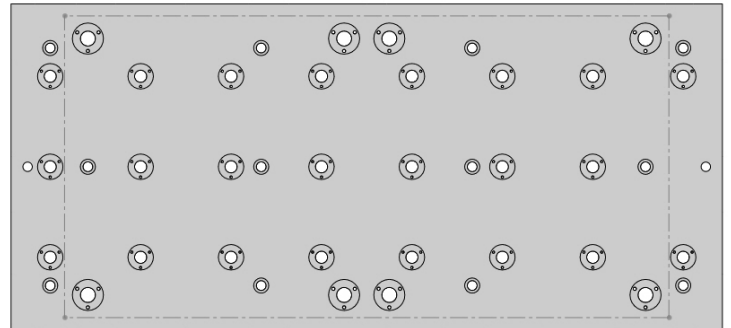
☐ 49406 6" Vise Ball Lock® Base



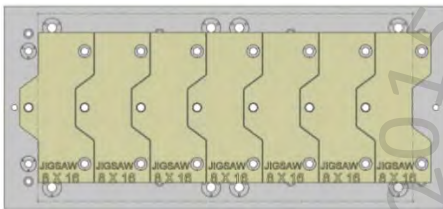
FJV250-008



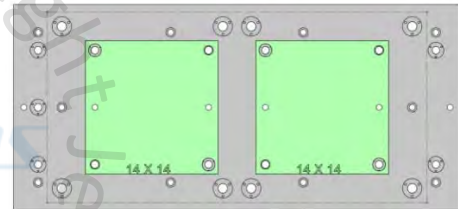
47.2 X 21.6 X 1.25



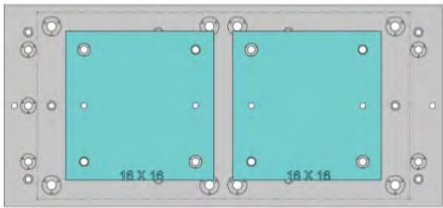
☐ FJV250-008



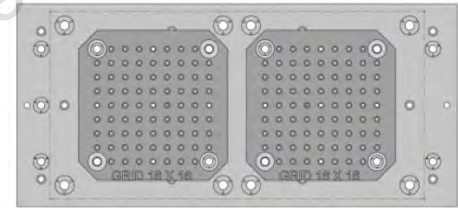
☐ 28705 Aluminum ☐ 28805 Steel



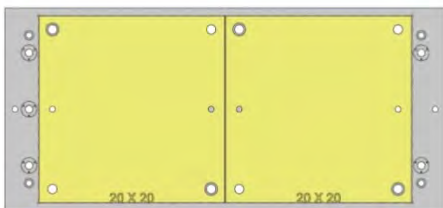
☐ 28713 Aluminum ☐ 28813 Steel



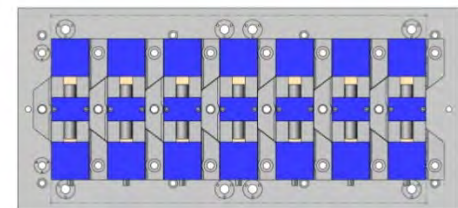
☐ 28715 Aluminum ☐ 28815 Steel



☐ 28801 Steel



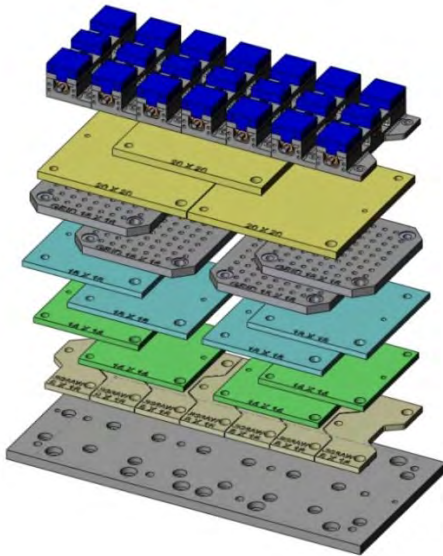
☐ 28727 Aluminum ☐ 28827 Steel



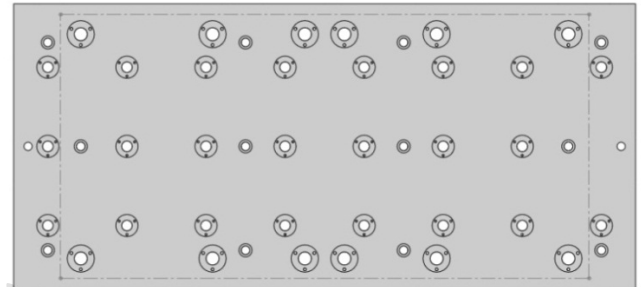
☐ 49405 4" Vise Ball Lock® Base



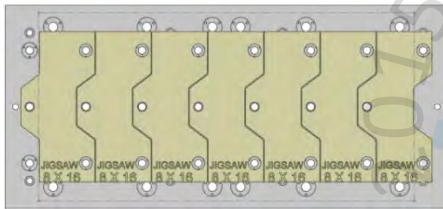
FJV250-009



47.2 X 21.6 X 1.25

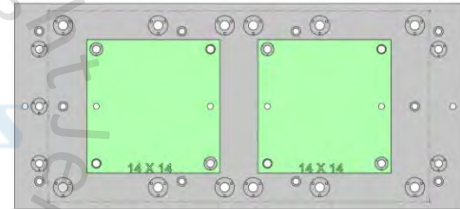


☐ FJV250-009



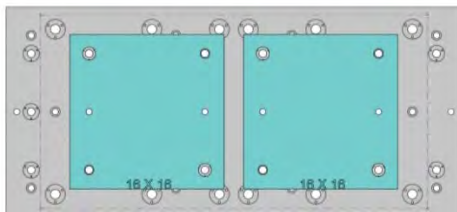
☐ 28705 Aluminum

☐ 28805 Steel



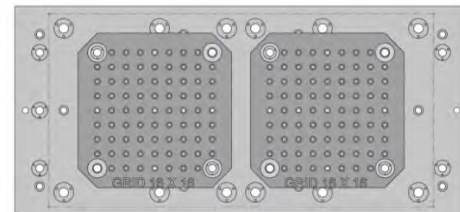
☐ 28713 Aluminum

☐ 28813 Steel

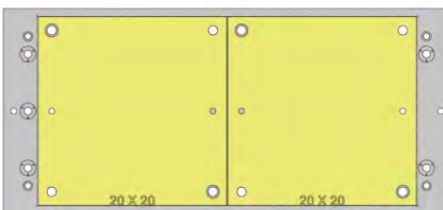


☐ 28715 Aluminum

☐ 28815 Steel

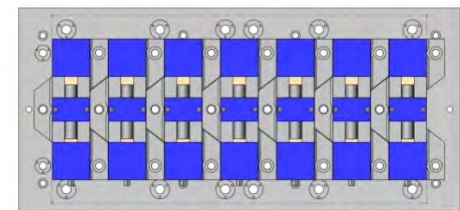


☐ 28801 Steel



☐ 28727 Aluminum

☐ 28827 Steel



☐ 49405 4" Vise Ball Lock® Base



Click Subplate P/N
For Quick Link

Subplate & Mounting Hardware Components required per Subplate							
SUBPLATE P/N	QTY	T-NUT P/N	QTY	SINE-KEY P/N	QTY	SHCS	QTY
VCN410A-001		43378	10	39564	2	771694	10
VCN410A-002		43378	10	39564	2	771694	10
VCN410A-003		43378	10	39564	2	771694	10
VCN410A-004		43378	10	39564	2	771694	10
VCN410A-005		43378	8	39564	2	771694	8
VCN410B-001		43378	10	39564	2	770182	10
VCN410B-002		43378	10	39564	2	770182	10
VCN410B-003		43378	10	39564	2	770182	10
VCN410B-004		43378	10	39564	2	770182	10
VCN410B-005		43378	10	39564	2	770182	10
VCN410B-006		43378	10	39564	2	770182	10
VCN410B-007		43378	10	39564	2	770182	10
VCN410B-008		43378	12	39564	2	770182	12
VCN410B-009		43378	12	39564	2	770182	12
VCN410B-010		43378	12	39564	2	770182	12
VCN510C-001		43378	16	39564	2	770182	16
VCN510C-002		43378	16	39564	2	770182	16
VCN510C-003		43378	16	39564	2	770182	16
VCN510C-004		43378	16	39564	2	770182	16
VCN510C-005		43378	16	39564	2	770182	16
VCN510C-006		43378	17	39564	2	770182	17
VCN510C-007		43378	17	39564	2	770182	17
VCN510C-008		43378	17	39564	2	770182	17
VCN510C-009		43378	17	39564	2	770182	17
VCN510C-010		43378	17	39564	2	770182	17
VCN510C-011		43378	17	39564	2	770182	17
FJV200-001		43378	8	39564	2	771694	8
FJV200-002		43378	8	39564	2	771694	8
FJV200-003		43378	8	39564	2	771694	8
FJV200-004		43378	8	39564	2	771694	8
FJV200-005		43378	8	39564	2	771694	8
FJV250-001		43378	12	39564	2	770182	12
FJV250-002		43378	12	39564	2	770182	12
FJV250-003		43378	12	39564	2	770182	12
FJV250-004		43378	12	39564	2	770182	12
FJV250-005		43378	12	39564	2	770182	12
FJV250-006		43378	12	39564	2	770182	12
FJV250-007		43378	12	39564	2	770182	12
FJV250-008		43378	12	39564	2	770182	12
FJV250-009		43378	12	39564	2	770182	12



FIXTURE PLATE ALUMINUM PART NO	ORDER QTY	FIXTURE PLATE STEEL PART NO	ORDER QTY	BALL-LOCK SHANKS PART NO	QTY OF SHANKS REQUIRED PER FIXTURE PLATE	ORDER QTY
		28801		49602	4	
28705		28805		49601	3	
28706		28806		49601	3	
28711		28811		49601	4	
28713		28813		49601	4	
28715		28815		49601	4	
28719		28819		49601	4	
28727		28827		49612	4	
28745		28845		49612	4	

BALL-LOCK BASE VISE 4"	ORDER QTY	BALL-LOCK BASE VISE 6"	ORDER QTY	BALL-LOCK SHANKS PART NO	QTY OF SHANKS REQUIRED PER FIXTURE PLATE	ORDER QTY
49405		49406		49601	3	